

# PRELIMINARY SITE PLAN

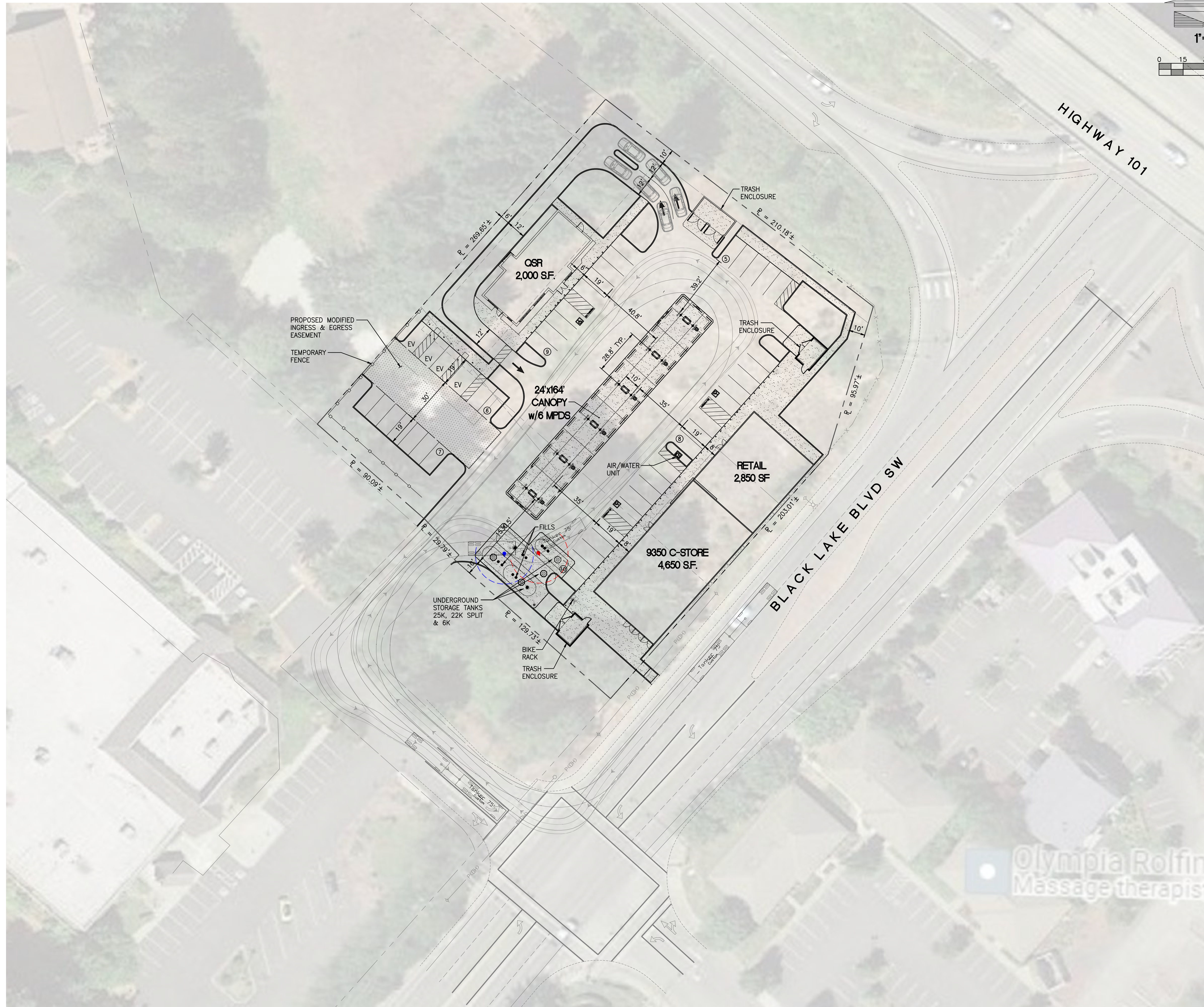

### PROJECT DATA

LOCATION: NWC BLACK LAKE BLVD @ HIGHWAY 101  
OLYMPIA, WASHINGTON

LOT AREA: 68,429 S.F. (1.57 ACRES)

### BUILDING SETBACKS:

FRONT SETBACK: NONE  
SIDE SETBACK: 10 FEET ABUTTING A STREET; NO SETBACK FOR INTERIOR PROPERTY LINES  
REAR SETBACK: 10 FEET

### LANDSCAPE SETBACKS:

PERIMETER LANDSCAPING: 10 FEET ALONG ROW; 5 FEET ALONG INTERIOR PROPERTY LINES  
INTERIOR LANDSCAPING:

- LANDSCAPING ISLANDS SHALL BE PLACED AT THE END OF EVERY PARKING ROW AND WITH A SPACING OF APPROXIMATELY ONE (1) ISLAND FOR EVERY NINE (9) PARKING SPACES.
- ISLANDS SHALL BE LOCATED BETWEEN LOADING DOORS/MANEUVERING AREAS AND PARKING AREA.
- LANDSCAPE ISLANDS MUST BE A MINIMUM OF ONE HUNDRED FORTY-FOUR (144) SQUARE FEET. ISLANDS MUST BE DESIGNED SO THAT TREES WILL BE PLANTED A MINIMUM OF SIX (6) FEET FROM ANY HARD SCAPE SURFACE.

### PARKING REQUIREMENTS:

C-STORE: 1 STALL PER 300 S.F. MIN.  
4,650 S.F./300 S.F. = 15.5 STALLS  
RETAIL: 3.5 STALLS PER 1,000 S.F. MIN.  
2,850 S.F./1000 S.F. x3.5 = 10 STALLS  
QSR: 10 STALLS PER 1,000 S.F. MIN.  
2,000 S.F./1000 S.F. x10 = 20 STALLS  
PARKING SPACES REQUIRED: 46 STALLS  
PARKING SPACES PROVIDED: 47 PARKING STALLS

No.	Date	By	Chk.	Appr.	Revision

For: \_\_\_\_\_

Not for Construction

Scale:	Horizontal	Vertical
Designed	_____	_____
Drawn	_____	_____
Checked	_____	_____
Approved	_____	_____
Date	10/23/24	

**Barghausen Consulting Engineers, Inc.**  
18215 72nd Avenue South  
Kent, WA 98032  
425.251.6222 [barghausen.com](http://barghausen.com)

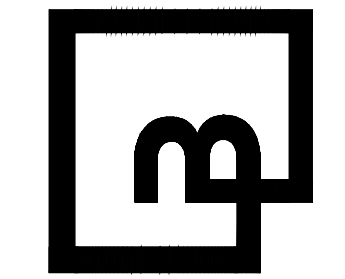

Job Number: 23747  
Sheet: SP-1

Preliminary Not For Construction

P:\23000s\23747\preliminary\23747 SP-1.dwg 10/24/2024 11:16 AM DJEDEL