

PRELIMINARY AREAS

BASEMENT	= 10,767 SF
MAIN FLOOR	= 10,664 SF
UPPER FLOOR	= 9,346 SF
TOTAL	= 30,777 SF

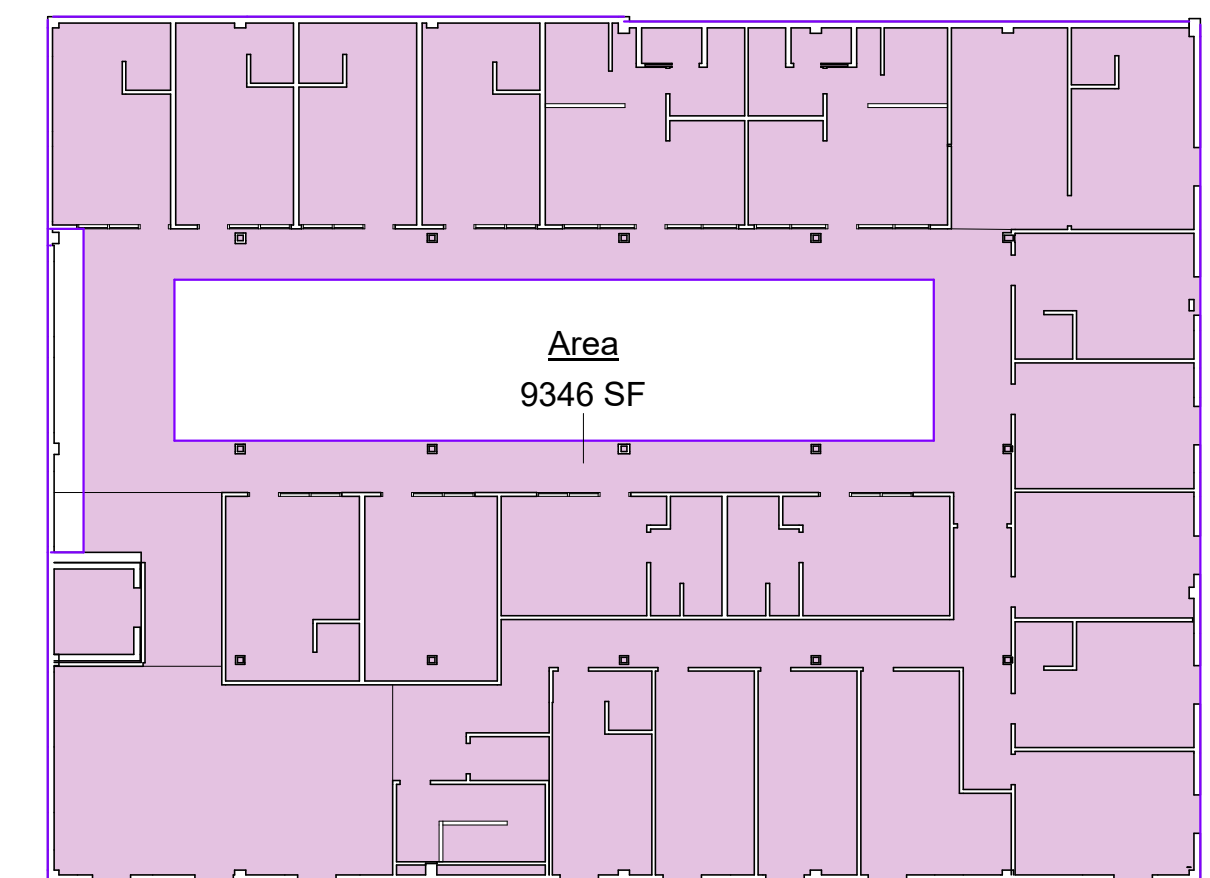

3RD FLOOR GROSS AREA

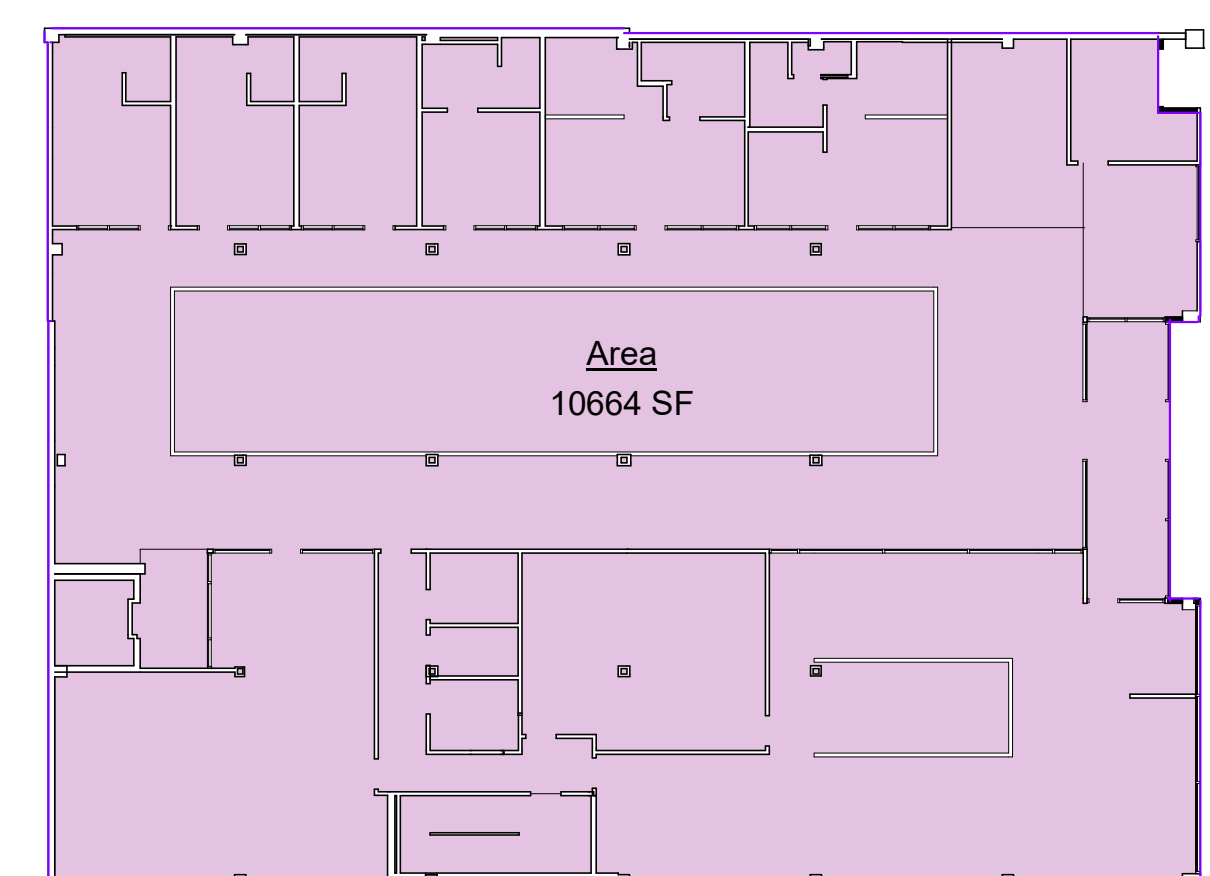

MAIN FLOOR GROSS AREA

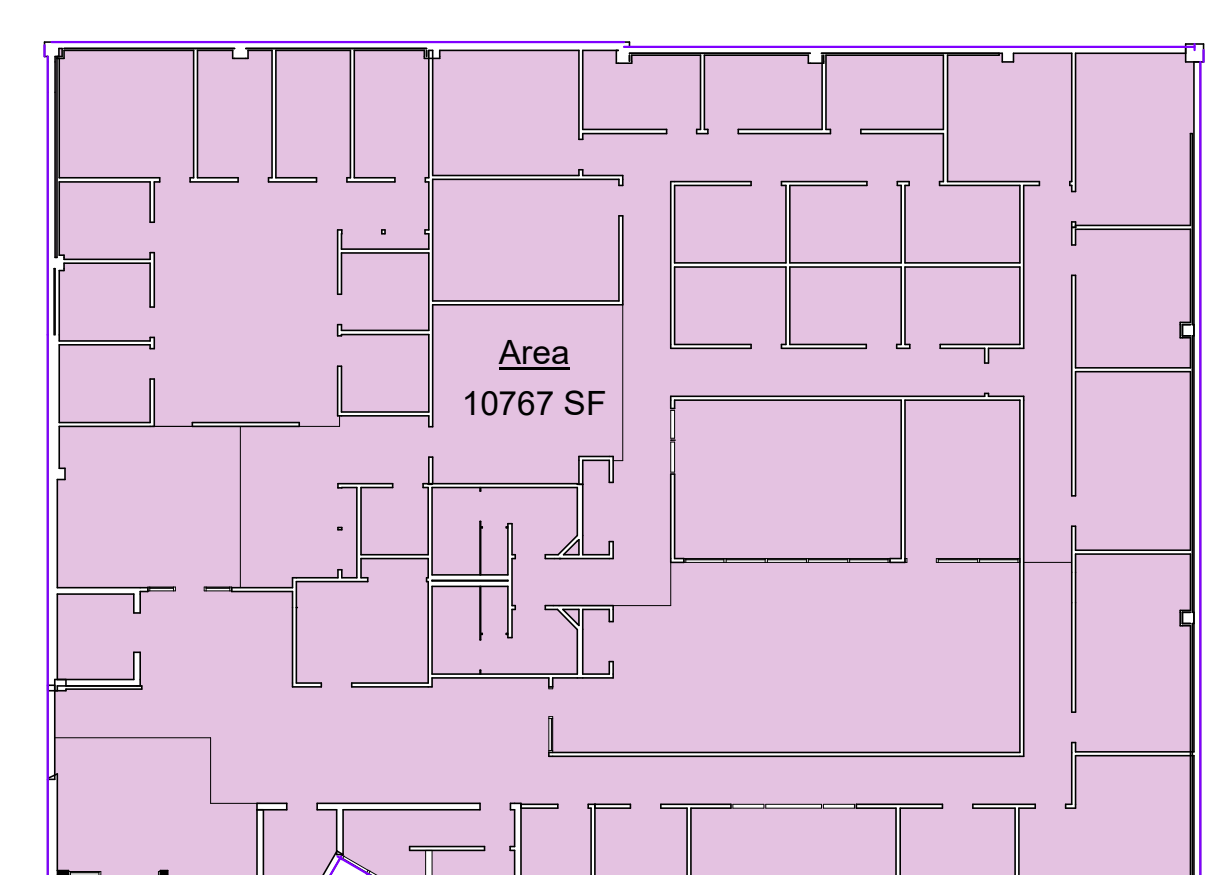

BASEMENT FLOOR GROSS AREA

521 S CAPITOL WAY OLYMPIA, WA 98501

LOCATION MAP

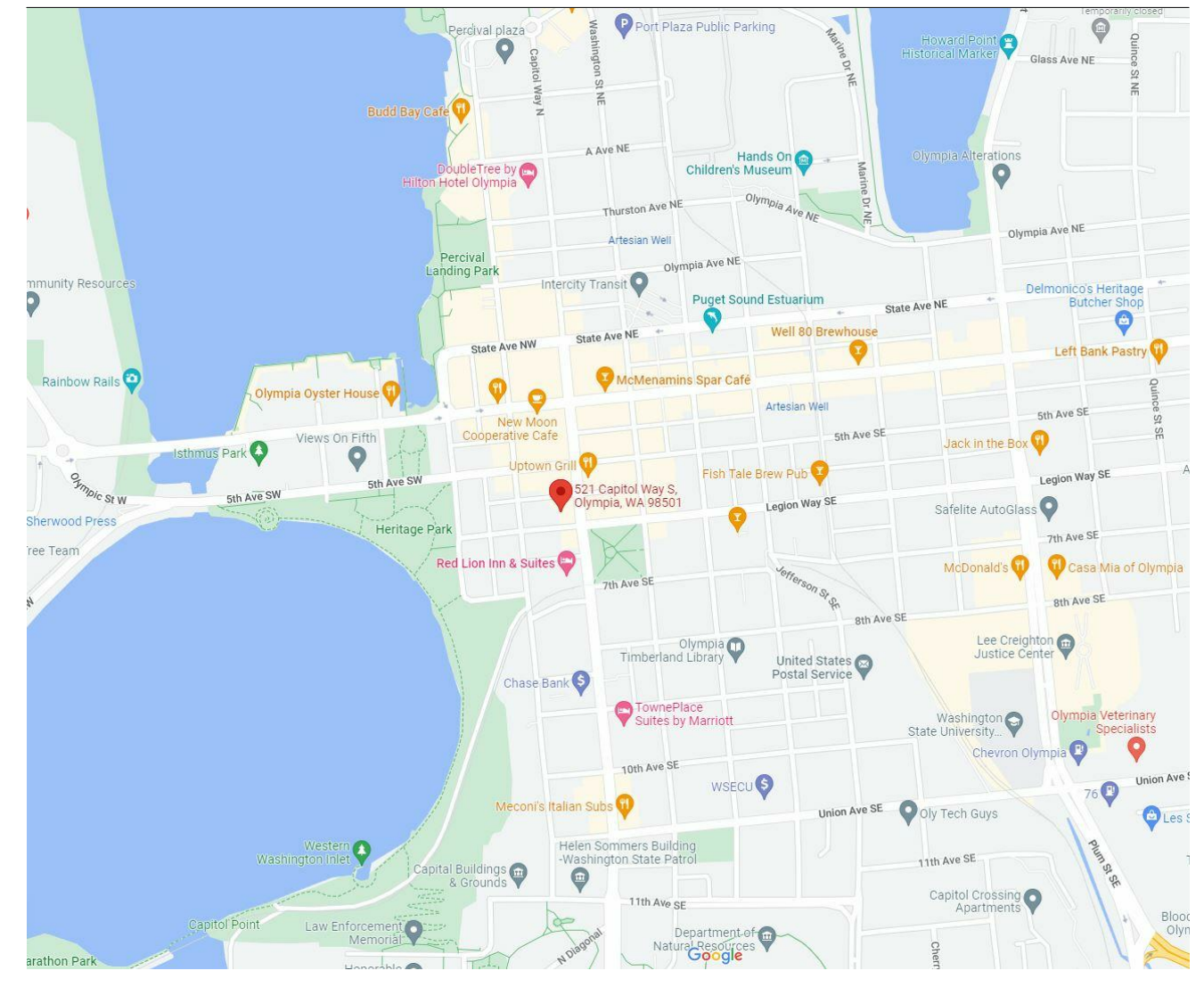

BUILDING PERMIT INFORMATION

MODEL CODE: IEBC - EXISTING BUILDING, IMPROVEMENTS OVER 50% OF BUILDING VALUE
CONSTRUCTION TYPE: (2) ABOVE GRADE, BASEMENT
BUILDING HEIGHT: 39'-7"
OCCUPANCY TYPE: CHANGE OF USE - FROM B TO R-1 (BOTIQUE HOTEL), A-2 (SUSHI RESTAURANT & WINE TASTING/TEA ROOM), B (OFFICE SPACES), P (PARKING)

BUILDING AREA
 BUILDING: 30,777 SQ. FEET
 SITE: 10,800 SQ. FEET

SITE ADDRESS: 521 CAPITOL WAY SE, OLYMPIA WA 98501
TAX PARCEL NUMBER(S): 78500600700
ABBREVIATED LEGAL DESCRIPTION: SYLVESTER L 6 B 6 S 1/2 & L 7
ZONING: BD (BUSINESS DISTRICT)
JURISDICTION: CITY OF OLYMPIA

PRELIMINARY DESIGN TEAM

PROPERTY OWNER
 REIN COMPANIES, LLC
 100 BAYVIEW CIRCLE, STE 100
 NEWPORT BEACH, CA 92660

CONTACT:
 PHONE: 857-654-8844
 EMAIL:

ARCHITECT
 ARTISANS GROUP
 6504 CAPITOL BLVD SE
 TUMWATER, WA 98501

CONTACT:
 PHONE: 253-302-4761
 EMAIL: JENNYCOMBS@OUTLOOK.COM
 PHONE:
 EMAIL:

STRUCTURAL ENGINEER
 NAME:
 ADDRESS:
 ADDRESS:

CONTACT:
 PHONE:
 EMAIL:

SHEET INDEX - PRELIMINARY

- A000 PRELIMINARY COVER SHEET
- A001 PRELIMINARY - SITE PLAN
- A002 PRELIMINARY - BASEMENT FLOOR
- A003 PRELIMINARY - MAIN FLOOR
- A004 PRELIMINARY - UPPER FLOOR
- A005 PRELIMINARY ROOF PLAN