

Ordinance No. \_\_\_\_\_

**AN ORDINANCE OF THE CITY OF OLYMPIA, WASHINGTON, ANNEXING TO THE CITY OF OLYMPIA APPROXIMATELY 205 ACRES LYING CONTIGUOUS TO THE CITY OF OLYMPIA AND WITHIN THE OLYMPIA URBAN GROWTH AREA, REFERRED TO AS THE "BOULEVARD/I-5 ANNEXATION," SITUATED IN THE NORTH HALF OF THE NORTHEAST QUARTER OF SECTION 24, THE EAST HALF OF THE SOUTHWEST QUARTER OF SECTION 13, TOWNSHIP 18 NORTH, RANGE 2 WEST, WILLAMETTE MERIDIAN, THE SOUTH HALF OF SECTION 18, THE NORTH HALF OF SECTION 19, TOWNSHIP 18 NORTH, RANGE 1 WEST, WILLAMETTE MERIDIAN, THURSTON COUNTY, WASHINGTON.**

**WHEREAS**, during 2009, the Washington State Legislature passed ESSB 5808, amending RCW 35A.14, allowing code cities to annex territory served by one or more fire districts; and

**WHEREAS**, RCW 35A.14.480 authorizes code cities to accomplish the annexation by ordinance after entering into an interlocal agreement with the affected fire district(s) and County; and

**WHEREAS**, on May 18, 2010, the City of Olympia did, according to the requirements under RCW 35A.14.480, notify Lacey Fire District Three and Thurston County of its desire to enter into an interlocal agreement; and

**WHEREAS**, on February 18, 2014, the Thurston County Board of Commissioners approved the interlocal agreement; and

**WHEREAS**, on February 20, 2014, Lacey Fire District Three approved the interlocal agreement; and

**WHEREAS**, on March 4, 2014, the Olympia City Council approved the interlocal agreement; and

**WHEREAS**, the proposed annexation is situated in a "County island" that is entirely surrounded by the City of Olympia; and

**WHEREAS**, both emergency police and fire protection services are already currently provided by the City of Olympia through mutual aid agreements with Lacey Fire District Three and Thurston County; and

**WHEREAS**, Goal UGM2 of the City of Olympia/Thurston County Joint Plan supports annexation of unincorporated islands within City limits; and

**WHEREAS**, the City of Olympia hosted public informational meetings on December 18, 2013, and March 10, 2014, to inform all residents and property owners of the area of this proposal and to provide information regarding the annexation; and

**WHEREAS**, on March 18, 2014, the Olympia City Council determined that the annexation of the hereinafter described property to the City of Olympia would be in the public interest and for the public welfare and in the best interest of the City of Olympia and the citizens thereof;

**NOW, THEREFORE, THE OLYMPIA CITY COUNCIL ORDAINS AS FOLLOWS:**

**Section 1. Annexation.** The property described and depicted in Exhibit A attached hereto and incorporated herein as if fully set forth, is hereby annexed to the City of Olympia.

**Section 2. Existing Indebtedness.** It is hereby further declared that upon annexation, the property described in Section 1 above shall be subject to existing indebtedness of the City of Olympia.

**Section 3. Solid Waste Collection.** Pursuant to RCW 35A.14.900, on the effective date of this Ordinance any franchise or permit theretofore granted to any person, firm or corporation by the State of Washington, or by the governing body of such annexed territory, authorizing or otherwise permitting the operation or any public utility, including but not limited to, public water, transportation, garbage disposal, or other similar public service business or facility within the limits of the annexed territory is cancelled. The holder of any such franchise permit canceled pursuant to this section and RCW 35A.14.900 is hereby granted a franchise to continue such business within the annexed territory for a term of not less than seven (7) years from the date of this Ordinance. The City shall not extend similar or competing services to the annexed territory except upon a proper showing of the inability or refusal of such person, firm or corporation to adequately service said annexed territory at a reasonable price. This section may be superseded by subsequent mutual agreement of the City of Olympia and a franchise holder.

**Section 4. Effective Date.** This Ordinance shall be in effect at the end of the day (midnight) June 20, 2014.

**Section 5. Development Applications.** Between the adoption and the effective date of this Ordinance, if requested by Thurston County, the City of Olympia will assume responsibility for reviewing development applications in the County island and would thus be entitled to the applicable permit review fees.

**Section 6. Severability.** The provisions of this Ordinance are declared separate and severable. If any provision of this Ordinance or its application to any person or circumstances is held invalid, the remainder of this Ordinance or application of the provision to other persons or circumstances shall be unaffected.

**Section 7. Ratification.** Any act consistent with the authority and prior to the effective date of this Ordinance is hereby ratified and affirmed.

---

STEPHEN H. BUXBAUM, MAYOR

**ATTEST:**

---

CITY CLERK

**APPROVED AS TO FORM:**

*Darren Nienaber*

---

DEPUTY CITY ATTORNEY

**PASSED:**

**APPROVED:**

**PUBLISHED:**

Date: January 27, 2014  
Project: I-5 Corridor Annexation  
Sheet: 1 of 3

**EXHIBIT "A"**  
**CITY OF OLYMPIA I-5 CORRIDOR ANNEXATION AREA**

I-5 Corridor Annexation Area, situated in the North Half of the Northeast Quarter of Section 24, the East Half of the Southwest Quarter of Section 13, Township 18 North, Range 2 West, Willamette Meridian, the South Half of Section 18, the North Half of Section 19, Township 18 North, Range 1 West, Willamette Meridian, Thurston County, Washington, said Annexation Area is contained and bounded within the following described area:

Commencing at the Section corner common to said Sections 13,24,18, and 19; thence North along the common North-South Section line of said Sections 13 and 18 to the South Right-of-Way of Interstate 5 being the **POINT OF BEGINNING**;

Thence continuing North along said common North-South Section line to the Centerline of Pacific Avenue;

Thence Northwesterly along said centerline to the intersection with the extension of the Easterly boundary line of Fir Grove Business Park BSP, Volume 1, Page 27, Thurston County records;

Thence South along said boundary line to the Southeasterly corner of same;

Thence West along said BSP South line to the East line of Lot 10 of said BSP;

Thence South along said East Lot line to the Southeasterly corner of said Lot 10;

Thence West along the South line of said BSP to the centerline of Boulevard Road;

Thence South along said Boulevard Road centerline to the intersection with the extended North boundary line of Short Plat 03-0206-OL, AFN 3645356, Thurston County records;

Thence East along said Short Plats North boundary line to the Northeasterly corner of same;

Thence South along the Easterly line of said Short Plat to the centerline of 7<sup>th</sup> Avenue;

Thence East along said 7<sup>th</sup> Avenue centerline to the intersection with the extended East Right-of-Way of Chambers Street;

Thence South along said Chambers Street Right-of-Way to the Northerly Right-of-Way of Interstate 5;

Date: January 27, 2014  
Project: I-5 Corridor Annexation  
Sheet: 2 of 3

Thence Southwesterly along said Interstate 5 Right-of-Way to the intersection with the North Right-of-Way of Union Avenue;

Thence West along said North Right-of-Way of Union Avenue extending to the East Right-of-Way of Fairview Street;

Thence South along said East Right-of-Way of Fairview Street to the intersection with the extended South Right-of-Way of 15<sup>th</sup> Avenue (Dayton Street);

Thence East along said South Right-of-Way of 15<sup>th</sup> Avenue to the intersection with the extended West Right-of-Way of Boulevard Road;

Thence Northerly along Boulevard Road to the intersection with the North Right-of-Way of 12<sup>th</sup> Avenue;

Thence East along said North Right-of-Way of 12<sup>th</sup> Avenue to the intersection with the West boundary of Creekwood PRD, Volume 24, Page 76, AFN 9004190053, Thurston County records;

Thence tracing along said Creekwood PRD exterior boundary in a clockwise direction to the intersection with the South line of the North Half of the Northwest Quarter of Section 19;

Thence East along said South line of the North Half of the Northwest Quarter and the South line of the North Half of the Northwest Quarter of the Northeast Quarter to the Southeast corner of the R.J. Smith Donation Land Claim (DLC) No. 42;

Thence North along the East line of said DLC No. 42 and extension thereof to the South Right-of-Way of Interstate 5;

Thence tracing along said South Right-of-Way of Interstate 5 to the **POINT OF BEGINNING**.

Said Annexation Area contains 193 acres more or less.



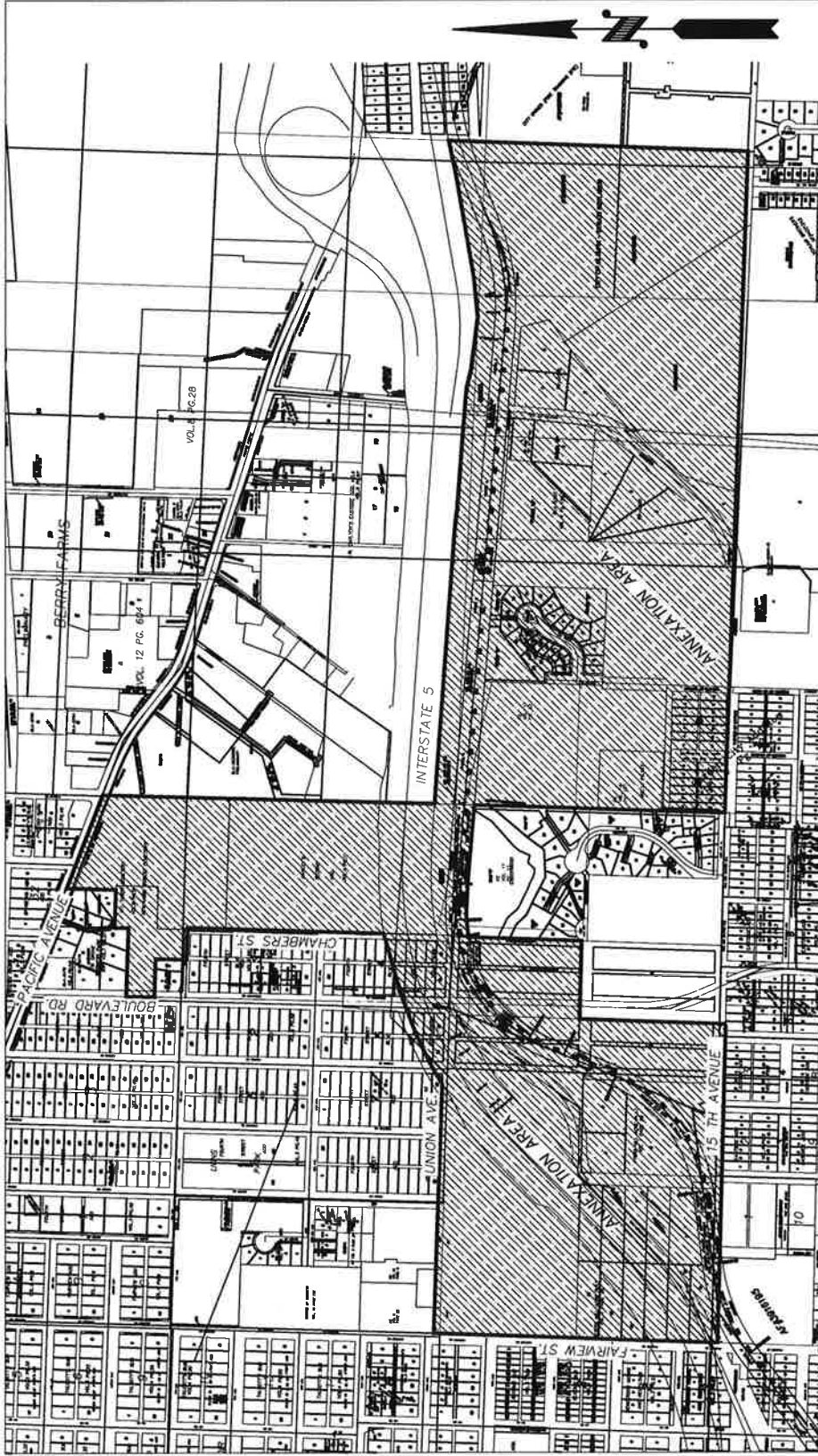

**NOTE:** This sketch was prepared to assist with the interpretation of the attached legal description. If conflicts arise between the written legal description and this sketch, the written legal description shall prevail.

DRAWN	BAM	PROJECT NO.	CITY OF OLYMPIA	DRAWING NAME
QC REVIEW	LC	CP&D Annexation	EXHIBIT "A"	
SCALE	1"=800'	DATE	INTERSTATE 5 CORRIDOR	
		1/2014	ANNEXATION AREA	SHEET 3 OF 3