

3707 000 0021

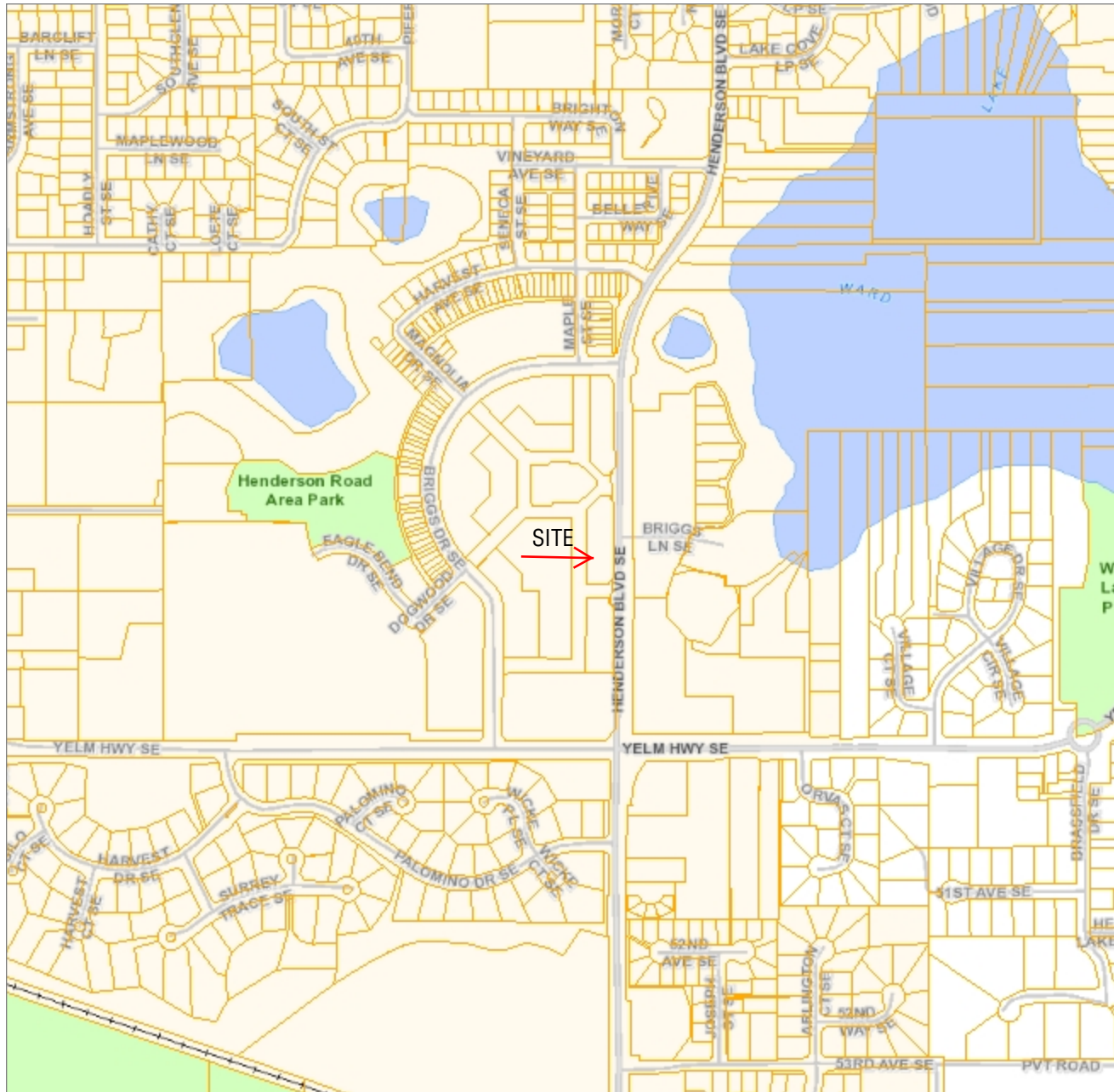

Legend

- | | |
|---|---|
| Parcels | Parks |
| Parcel Boundaries | Cities |
| Roads - Major (Large Scale) | Capital Forest |
| <all other values> | County Background |
| I 5 ACCESS; US 101 ACCESS; US 101 SB OFF RAMP | Roads - Major |
| I 5; US 101 | <all other values> |
| Roads (Large Scale) | I 5 ACCESS; US 101 ACCESS; US 101 SB OFF RAMP |
| Railroads | I 5; US 101 |
| County Border | Roads |
| Olympia Municipal Airport | Railroads |
| Water Bodies (River - Small Scale) | County Border |
| Water Bodies (Other) | Olympia Municipal Airport |
| | Water Bodies (River - Small Scale) |

Scale 1: 12,119

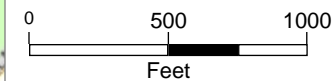

Map Created Using GeoData Public Website

Published: 6/8/2022

Note:



The information included on this map has been compiled by Thurston County staff from a variety of sources and is subject to change without notice. Additional elements may be present in reality that are not represented on the map. Ortho-photos and other data may not align. The boundaries depicted by these datasets are approximate. This document is not intended for use as a survey product. ALL DATA IS EXPRESSLY PROVIDED 'AS IS' AND 'WITH ALL FAULTS'. Thurston County makes no representations or warranties, express or implied, as to accuracy, completeness, timeliness, or rights to the use of such information. In no event shall Thurston County be liable for direct, indirect, incidental, consequential, special, or tort damages of any kind, including, but not limited to, lost revenues or lost profits, real or anticipated, resulting from the use, misuse or reliance of the information contained on this map. If any portion of this map or disclaimer is missing or altered, Thurston County removes itself from all responsibility from the map and the data contained within. The burden for determining fitness for use lies entirely with the user and the user is solely responsible for understanding the accuracy limitation of the information contained in this map. Authorized for 3rd Party reproduction for personal use only.