

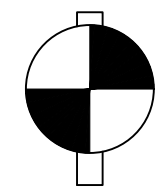

SCALE: 1"=20 FEET  
0 10 20 40



CITY OF OLYMPIA  
VERTICAL DATUM NAVD 88



10/17/17

NOTES:  
PROJECT #1743H

#	REVISION	DATE

ISTHMUS INTERIM  
PARK IMPROVEMENTS

SITE PLAN

DESIGNED SG/JL  
DRAWN SG/JL  
CHECKED KS/JL  
DATE 10/17/17

C2.1

SHEET 4 OF 10



Know what's below.  
Call before you dig.

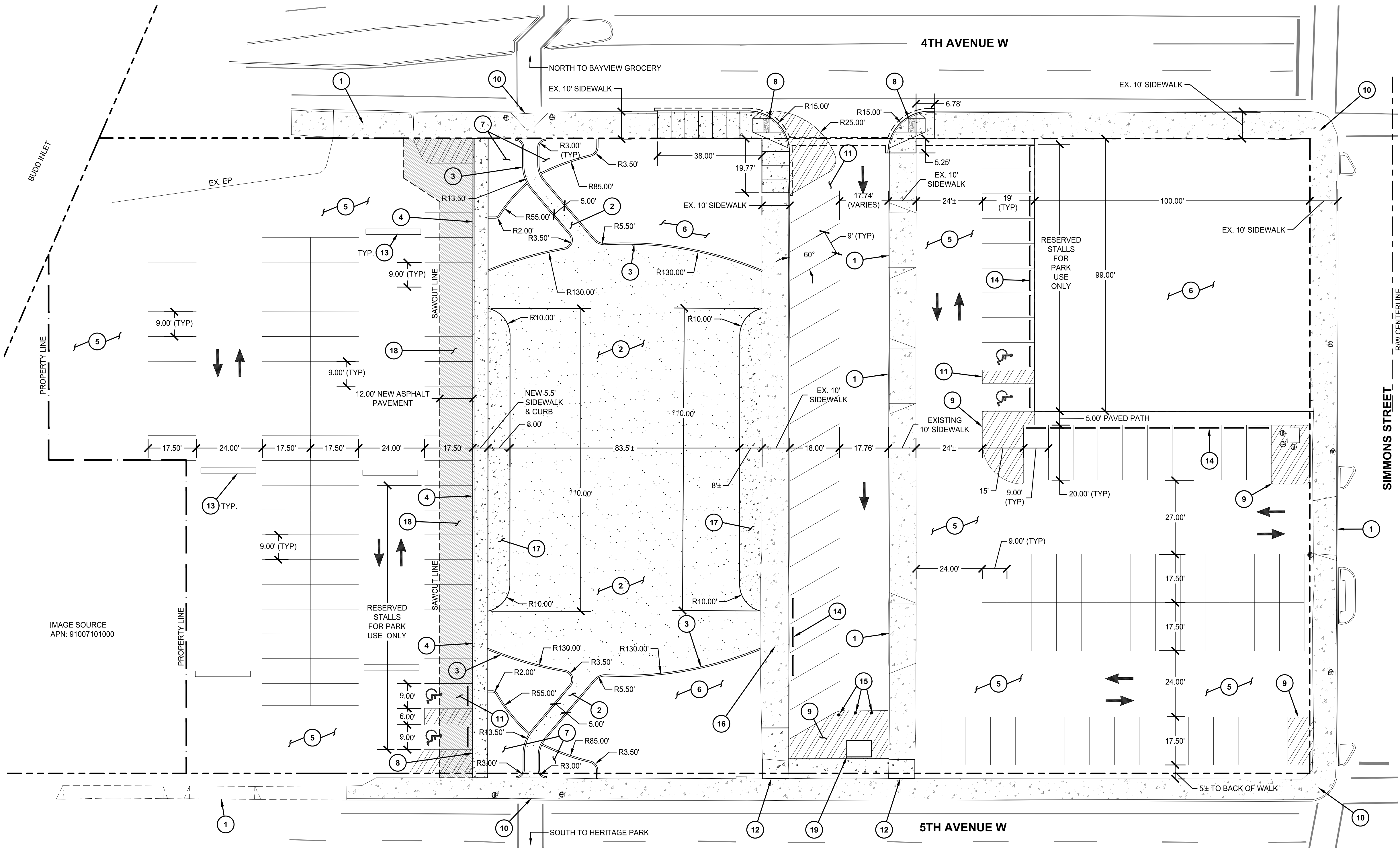

CONSTRUCTION STAKING

THE IMPROVEMENTS DEPICTED ON THESE PLANS SHALL BE STAKED IN THE FIELD BY A LICENSED LAND SURVEYOR CAPABLE OF PERFORMING SUCH WORK. THE ENGINEER MAY RELEASE DIGITAL COPIES OF THESE PLANS TO FACILITATE CONSTRUCTION STAKING. WHERE THERE IS A DISCREPANCY BETWEEN THE DIGITAL FILE AND PRINT COPY OF THESE PLANS, THE MOST CURRENT PRINT VERSION SHALL PREVAIL.

ONSITE PARKING NOTES

A TOTAL OF 20 PARKING STALLS (INCLUDING 4 ADA ACCESSIBLE) AND 4 BIKE LOCKERS HAVE BEEN PROVIDED FOR THIS PROJECT.

SITE PLAN & HORIZONTAL CONTROL NOTES

- EXISTING DRIVEWAY ACCESS TO REMAIN
- CRUSHED MARBLE SURFACING
- NEW 6" WIDE CONCRETE LANDSCAPE CURB
- NEW 5.5' WIDE MONOLITHIC CONCRETE CURB AND SIDEWALK
- EXISTING ASPHALT PARKING AREA AND DRIVE AISLES TO BE SEAL COATED AND LINES REPAINTED.
- NEW TURF LANDSCAPE AREA WITH TREES. SEE SHEET L1.3.
- NEW SHRUB AND MULCH LANDSCAPE AREA. SEE SHEET L1.3.
- CURB FLUSH WITH ASPHALT FINISHED GRADE. SEE SHEET C3.1.
- NO PARKING AREAS STRIPED TO CITY STANDARDS.
- EXISTING ADA CURB RAMP TO REMAIN. CONSTRUCTED TO PREVIOUSLY APPROVED STANDARD.
- ADA PARKING STALLS AND CURB FLUSH WITH ASPHALT (ZERO CURB HEIGHT)
- PROPOSED CONCRETE SIDEWALK EXTENSION. REMOVE EXISTING EXTRUDED CURB AND REPLACE PLANTER AREA WITH MONOLITHIC SIDEWALK PER PLAN.
- EXISTING SPEED BUMPS WITHIN PARKING AREA
- PRECAST BUMPER BLOCKS (TYP. OF 25) SEE DETAIL ON SHEET C3.2.
- INSTALL WSDOT TYPE 2 BOLLARDS (3 TOTAL), 6' SPACING.
- EXISTING CURB CUT/DRIVEWAY TO REMAIN; INSTALL BUMPER BLOCKS TO PREVENT VEHICLE ACCESS
- CONCRETE PLAZA SIDEWALK WITH ZERO HEIGHT CURB TRANSITION TO CRUSHED MARBLE SURFACING. SEE LANDSCAPE DETAILS ON SHEET L1.2 FOR BOULDER AND BENCH PLACEMENT.
- NEW ASPHALT PAVING AREA
- 6' X 9' COVERED BIKE SHELTER PER PROJECT SPECIFICATIONS.