

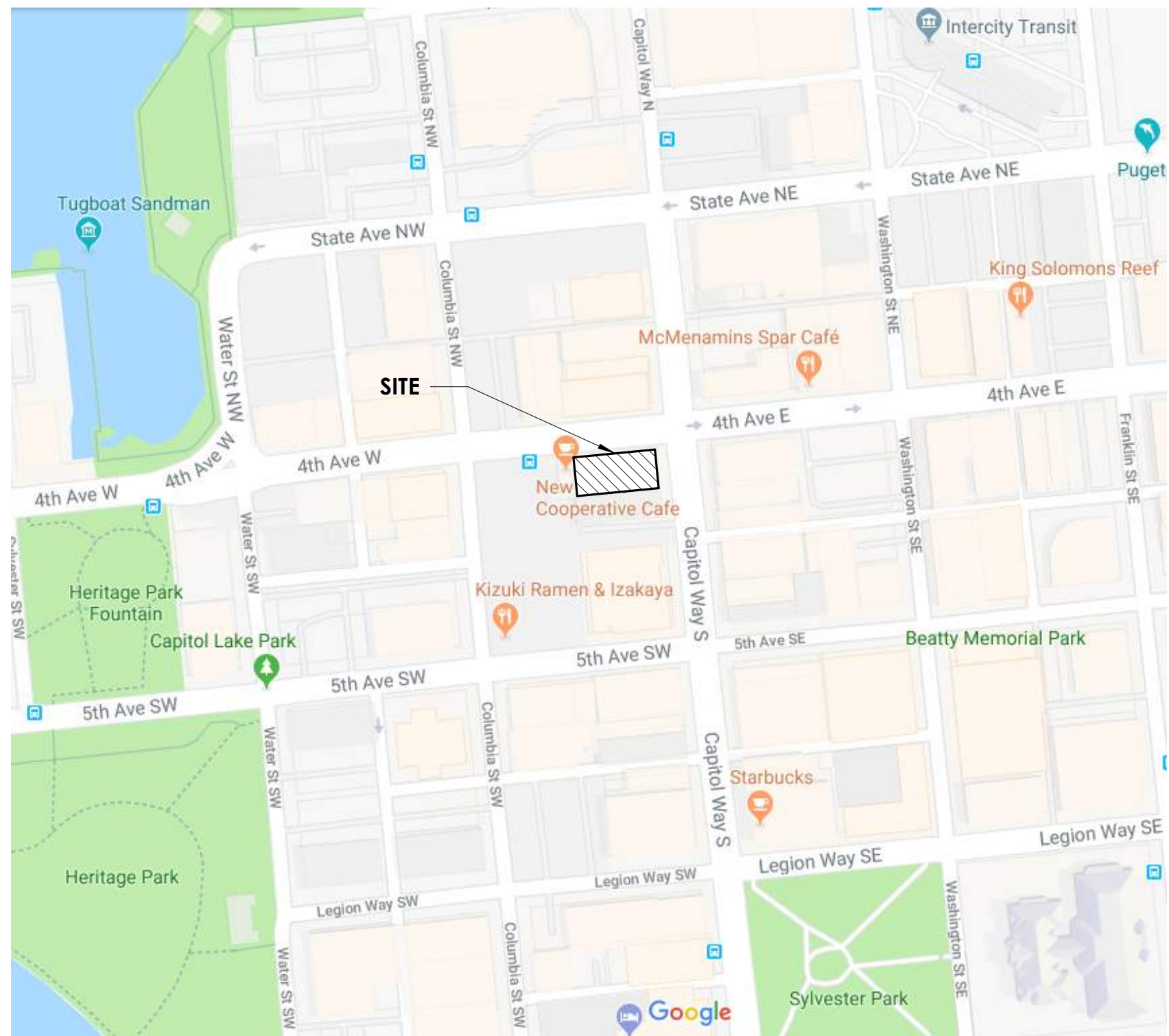

# OLYMPIA FEDERAL SAVINGS & LOAN SCHOENFELD

## VICINITY MAP



## CONTACTS

**PROPERTY OWNER:**  
OLYMPIA FEDERAL SAVINGS & LOAN  
P.O. Box 1338, Olympia, WA 98507  
OLYMPIA, WA 98507

**CONTACT:** OLYMPIA FEDERAL SAVINGS & LOAN

**ARCHITECT:**  
THOMAS ARCHITECTURE STUDIO, INC.  
525 COLUMBIA ST.  
OLYMPIA, WA 98501  
PHONE: 360-915-8775

**CONTACT:** JOSH GOBEL  
EMAIL: JOSH@TASOLYMPIA.COM

**CIVIL ENGINEER:**  
SCJ ALLIANCE  
8730 Tallon Lane NE, Suite 200  
Lacey, WA 98516

**CONTACT:** AMY HEAD  
EMAIL: AMYH@SCJALLIANCE.COM

## PROJECT NARRATIVE

THESE DAWINGS AND ASSOCIATED PERMIT APPLICATION ARE FOR THE COMPLETE DEMOLITION AND REMOVAL OF THE EXISTING THREE STORY BUILDING LOCATED AT THE CORNER OF 4TH AVE. AND CAPITOL WAY S. AND PREPARING THE SITE FOR FUTURE CONSTRUCTION.

## INADVERTENT DISCOVERY PLAN

DURING THE COURSE OF ANY PROJECT-RELATED GROUND DISTURBING ACTIVITIES (ILCUDING CONCRETE REMOVAL, EXCAVATION, OR INSTALLING OF PILINGS), HUMAN REMAINS, ARCHAEOLOGICAL AND OTHER UNDERGROUND HISTORICAL MATERIALS AND FEATURES WILL BE PROTECTED AS FOLLOWS:

1. **STOP WORK IMMEDIATELY** IF ANY CULTURAL/HISTORICAL MATERIALS OR HUMAN REMAINS ARE OBSERVED OR UNCOVERED DURING GROUND DISTURBANCE:

- BONES OR SMALL PIECES OF BONE,
- CLUSTERS OF SHELL OR BURNED ROCKS,
- AREAS OF CHARCOAL OR VERY DARK STAINED SOIL,
- STONE TOOLS, ARROWHEADS, BEADS, OR CERAMIC ARTIFACTS,
- HISTORICAL ARTIFACTS LIKE OLD BOTTLES, EQUIPMENT, TOOLS AND PERSONAL ITEMS,
- BUILDING FOUNDATIONS AND CLUSTERS OF OLD BUILDING MATERIALS, AND
- OLD RAILROAD TRACKS, ROAD SECTIONS, OR OTHER INDUSTRIAL MATERIALS.

NOTE: DO NOT RESUME GROUND DISTURBING WORK UNTIL A RESPONSE FROM THE APPROPRIATE AUTHORITIES IS COMPLETE.

2. IMMEDIATELY **CONTACT CITY OF OLYMPIA HISTORIC PRESERVATION OFFICER (OHPO)**, WHO CAN HELP COORDINATED A RESPONSE SO ANY DISCOVERIRES CAN BE APPROPRIATELY ADDRESSED BEFORE YOU CONTINUE WORK.

MICHELLE SADLIER  
OHPO  
CITY OF OLYMPIA  
CELL: 360-507-6636  
WORK: 360-753-8031  
EMAIL: MSADLIER@CI.OLYMPIA.WA.US

IF THE CITY'S HISTORIC OFFICER IS NOT AVAILABLE, CONTACT THE OTHER CONSULTIES LISTED BELOW IN ORDER SO AN IMMEDIATE RESPONSE CAN BE ARRANGED.

## SHEET INDEX

SHEET NUMBER	SHEET NAME
D-001	COVER SHEET
D-101	DEMOLITION PLAN
D-102	SIDEWALK CLOSURE PLAN
D-103	CLEAR SIGHT TRIANGLE
D-104	EXISTING CONDITIONS

3. IF THE OPHO IS NOT AVAILABLE TO ASSIST WITH THIS RESPONSE IMMEDIATELY NOTIFY THE STATE DEPARTMENT OF ARCHAEOLOGY AND HISTORIC PRESERVATION (DAHP).

GRETCHEN KAEHLER  
LOCAL GOVERNMENT ARCHAEOLOGIST  
DAHP  
CELL: 360-628-2755  
WORK: 360-586-3088  
EMAIL: GRETCHEN.KAEHLER@GAHP.WA.GOV

4. **DAHP WILL HELP COORDINATE THE INVOLVEMENT OF OTHERS** WHO MAY HAVE ALEGAL ROLE IN RESPONSE TO THE UNANTICIPATED DISCOVERY OF ARCHAEOLOGICAL MATERIALS OR HUMAN REMAINS DURING THE COURSE OF A DEVELOPMENT PROJECT. THESE MAY INCLUDE:

- INTERESTED TRIBES, INCLUDING BUT NOT LIMITED TO THE TRIBAL HISTORIC PRESERVATION OFFICERS FOR:
  1. THE NISQUALLY TRIBE (JACKIE WALL: 360-456-5221, X2180), AND
  2. THE SQUAXIN ISLAND TRIBE (RHONDA FOSTER: 360-432-3850)
- THE STATE PHYSICAL ANTHROPOLOGIST (FOR HUMAN REMAINS)
- LAW ENFORCEMENT (FOR HUMAN REMAINS)
- COUNTY CORONER ( FOR HUMAN REMAINS)

5. **PLEASE TREAT ANY HUMAN REMAINS WITH DIGNITY AND RESPECT.** COVER THE REMAINS WITH A TARP OR OTHER MATERIALS (NOT SOIL OR ROCKS) FOR TEMPORARY PROTECTION IN PLACE AND TO SHIELD THEM FROM BEING PHOTOGRAPHED. DO NOT CALL 911 OR SPEAK WITH THE MEDIA.

ONCE CONTACTED, THE ABOVE PARTIES WILL DETERMINE IF THERE ARE IMPORTANT ARCHAEOLOGICAL MATERIALS OR HUMAN REMAINS PRESENT WOULD THE APPROPROATE RESPONSE SO THAT YOU PROJECT CAN RESUME AS QUICKLY AS POSSIBLE.

## PROJECT TIMELINE

HEARINGS EXAMINER MEETING -----  
DEMOLITION PERMIT SUBMITTAL -----  
FOUNDATION PERMIT SUBMITTAL -----  
CIVIL ENGINEERING PERMIT SUBMITTAL -----  
BUILDING PERMIT SUBMITTALS -----

SITE FENCING AND TREE PROTECTION TO BE INSTALLED PRIOR TO DEMOLITION  
BUILDING REMOVAL TO COMMENCE UPON ISSUANCE OF DEMOLITION PERMITS.  
DURATION OF DEMOLITION EXPECTED TO BE ----- DAYS.  
SITE WORK AND FOUNDATION TO COMMENCE UPON COMPLETION OF DEMOLITION.  
BUILDING CONSTRUCTION TO COMMENCE UPON ISSUANCE OF NECESSARY PERMITS  
BUILDING COMPLETION EXPECTED ----- MONTHS FROM START OF CONSTRUCTION.

## BUILDING INFORMATION

DESCRIPTION: DEMOLITION ONE EXISTING STRUCTURE TOTALING APPPROX 20,718 SF

MODEL CODE:	2015 IBC
CONSTRUCTION TYPE:	VA
NUMBER OF STORIES:	3
BUILDING HEIGHT:	35 FEET
OCCUPANCY TYPE:	RTL

**BUILDING AREA TO BE REMOVED**

BUILDING FOOTPRINT	6670 SQ. FEET
BUILDING TOTAL	20,718 SQ. FEET

## SITE INFORMATION

SITE ADDRESS: 403 CAPITOL WAY S., OLYMPIA, WASHINGTON 98501

PARCEL #: 78500500200

ABBREVIATED LEGAL DESCRIPTION: SYLVESTER L 1 B 5 S 15F OF E 20F & L 2

JURISDICTION: CITY OF OLYMPIA

MASTER FILE # \_\_\_\_\_  
DRB, COMBINED DESIGN REVIEW APPROVAL ON \_\_\_\_\_  
LAND USE APPROVAL ON \_\_\_\_\_ ZONING: \_\_\_\_\_

\*\*SEE SITE PLAN FOR ADDITIONAL INFORMATION



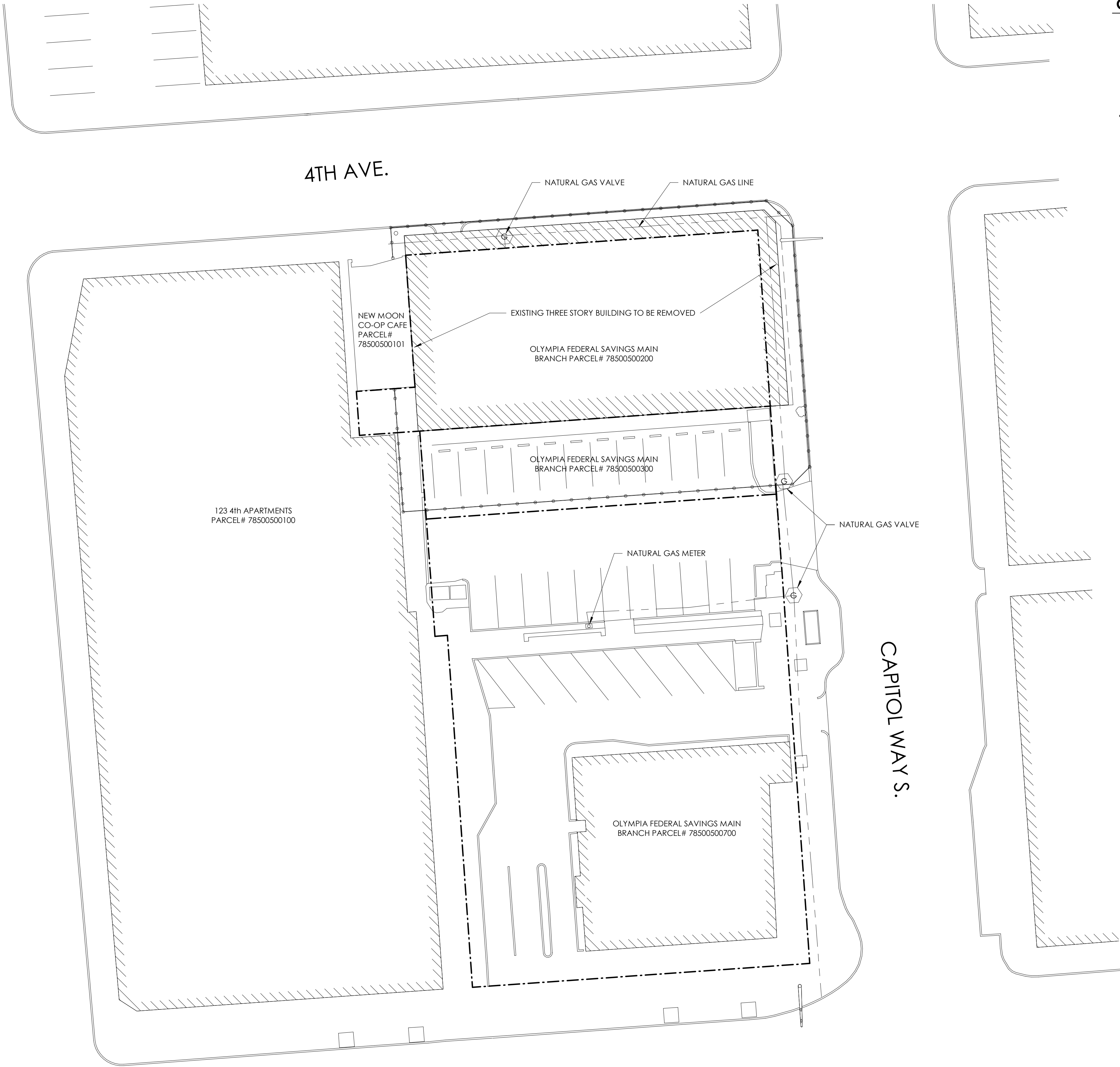

GENERAL DEMOLITION NOTES

1. CONTRACTOR TO COORDINATE FENCING INSTALL AROUND CITY OWNED PARCEL (PUMP STATION) WITH CITY OF OLYMPIA SEWER UTILITY.
2. LATERALS ONSITE SHALL BE REMOVED TO THE RIGHT OF WAY TO AVOID CONFLICT WITH THE NEW FOUNDATION.

- CHAIN LINK FENCE
- PROPERTY LINE
- NATURAL GAS LINE
- NATURAL GAS VALVE
- NATURAL GAS METER

SCHOENFELD  
OLYMPIA FEDERAL SAVINGS & LOAN  
430 CAPITOL WAY S. | OLYMPIA, WA

Project No: 1626  
DEMOLITION PERMIT  
06/25/18

DEMOLITION  
PLAN

D-101

All material herein constitutes the original and unpublished work of the architect and may not be used, duplicated, or disclosed without the written consent of the architect. Copyright © 2018 by Thomas Architecture Studio. All rights reserved.



TYPE III BARRICADE (A)



SIDEWALK CLOSED CROSS HERE SIGN (B)



SIDEWALK CLOSED SIGN (C)



DETOUR SIGN FOR PEDESTRIAN (D)



NO PEDESTRIAN CROSSING (E)

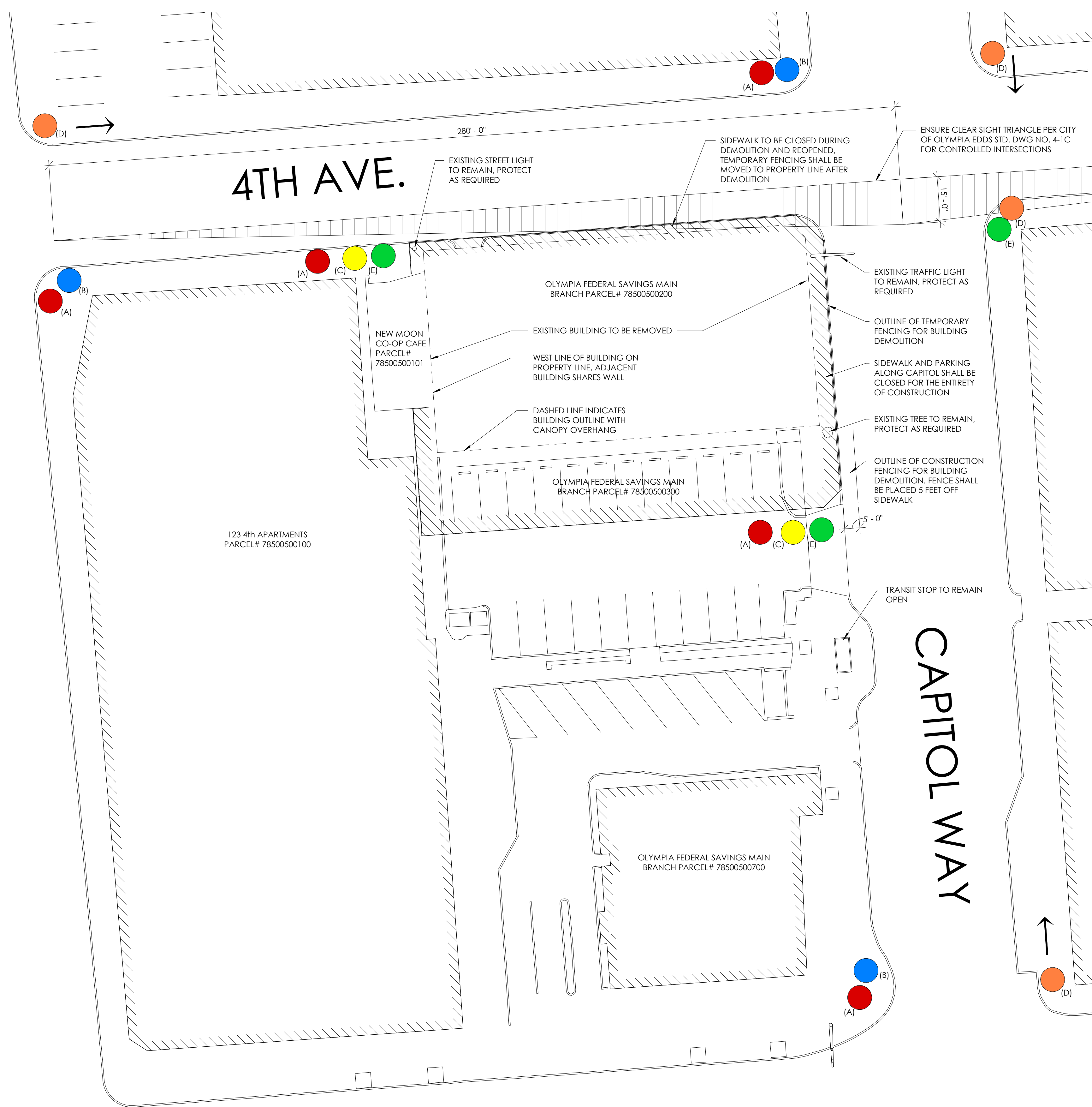

CONSTRUCTION / DEMOLITION NOTES

- EXISTING BUILDING
- FENCED BOUNDARY OF CONSTRUCTION AREA
- PROPERTY LINE
- CLEAR SIGHT TRIANGLE FOR STOP OR YIELD CONTROLLED INTERSECTIONS
- ARROWS INDICATE DIRECTION OF PEDESTRIAN DETOUR

1. CONTRACTOR TO COORDINATE WITH CITY, SALVAGE OF EXISTING STREET PARKING METERS, TRANSIT STOP, SIGNS, ETC.

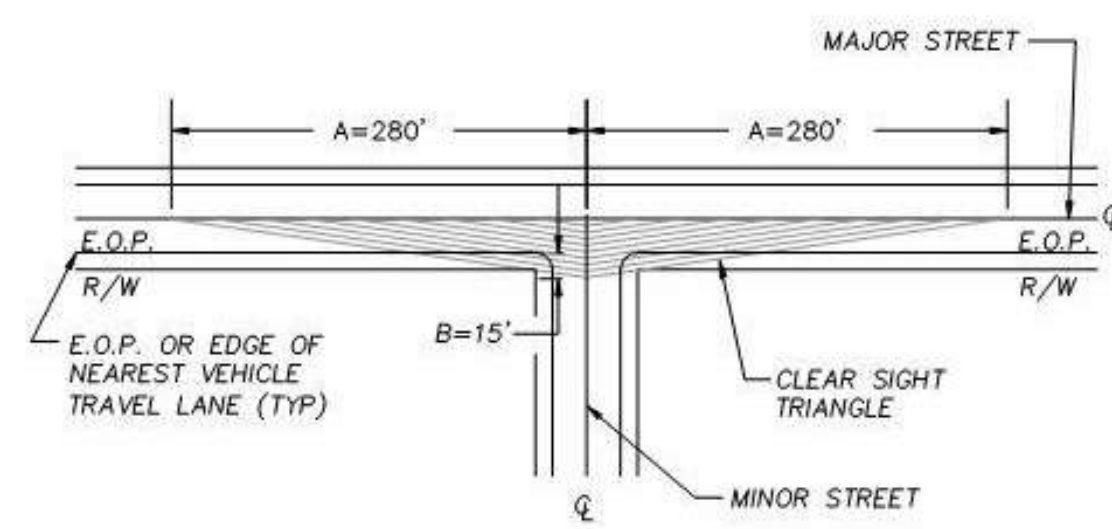

EXAMPLE  
MAJOR STREET SPEED LIMIT = 25 M.P.H.  
MINOR STREET SPEED LIMIT = 25 M.P.H.

CLEAR SIGHT TRIANGLE FOR STOP OR YIELD CONTROLLED INTERSECTIONS



TEMPORARY CHAIN LINK FENCE



SCHOENFELD  
OLYMPIA FEDERAL SAVINGS & LOAN  
430 CAPITOL WAY S. | OLYMPIA, WA

Project No: 1626  
DEMOLITION PERMIT  
06/25/18

CLEAR SIGHT  
TRIANGLE

D-103

All material herein constitutes the original and unpublished work of the architect and may not be used, duplicated, or disclosed without the written consent of the architect. Copyright © 2018 by Thomas Architecture Studio. All rights reserved.

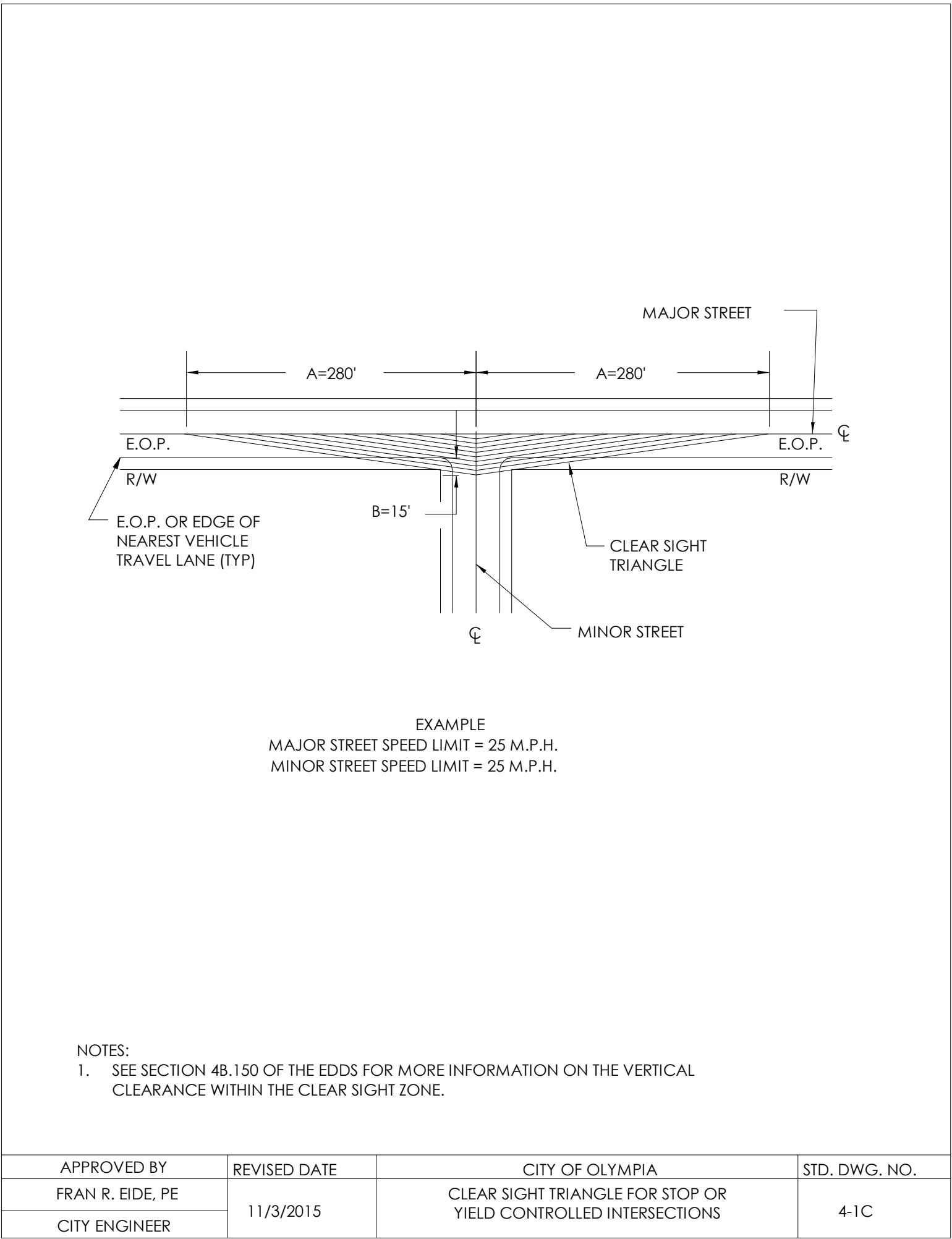



SCHOENFELD  
OLYMPIA FEDERAL SAVINGS & LOAN  
430 CAPITOL WAY S. | OLYMPIA, WA

Project No: 1626  
DEMOLITION PERMIT  
06/25/18

EXISTING  
CONDITIONS

D-104

All material herein constitutes the original and unpublished work of the architect and may not be used, duplicated, or disclosed without the written consent of the architect. Copyright © 2018 by Thomas Architecture Studio. All rights reserved.

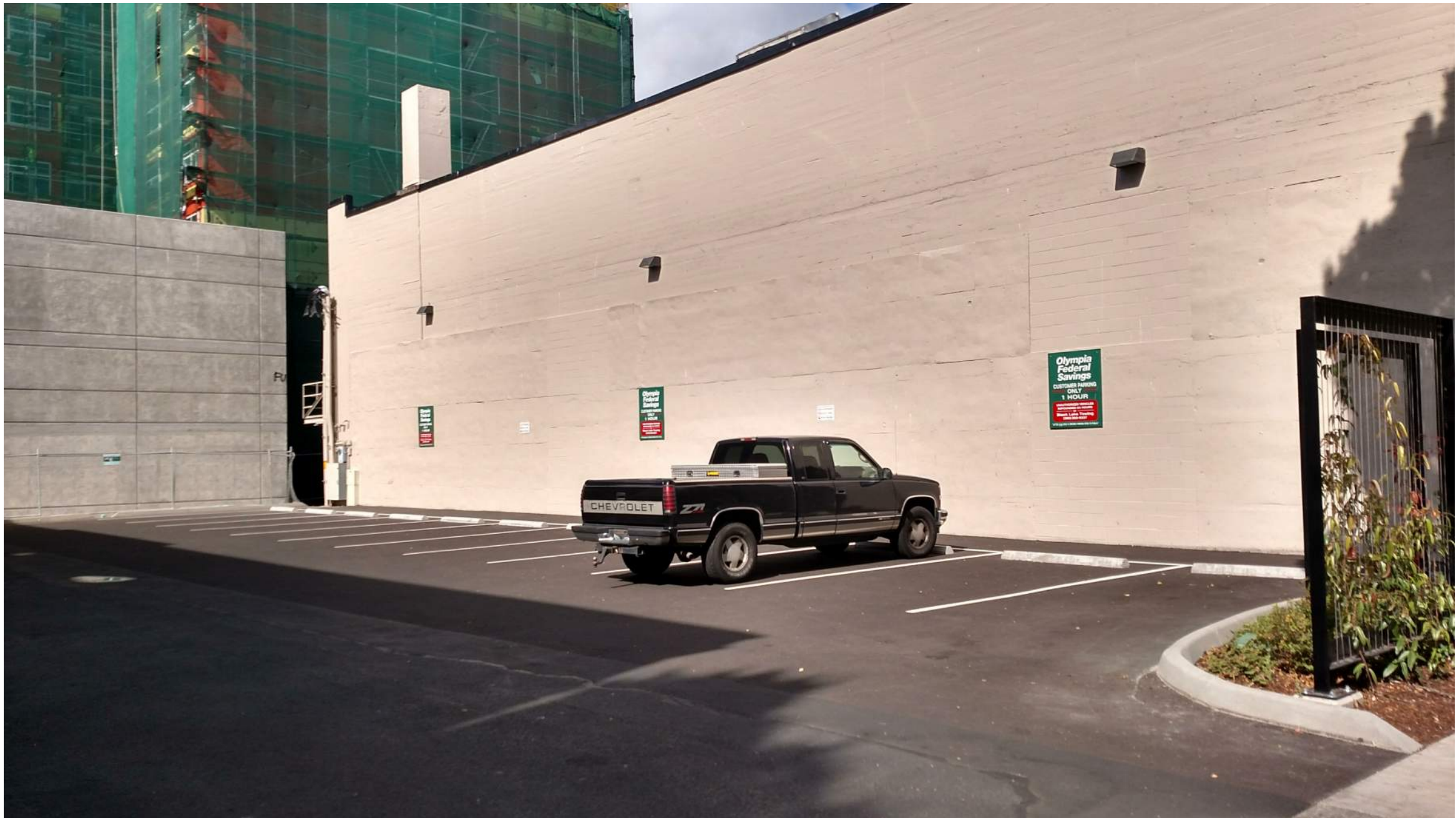

4 SOUTH PARKING  
3" = 1'-0"



2 AT CORNER OF 4TH AND CAPITOL  
3" = 1'-0"



3 AT SOUTH EAST CORNER  
3" = 1'-0"



1 AT 4TH  
3" = 1'-0"