

SEC. 28, T18N., R2W., W.M.

SOUTH PUGET SOUND COMMUNITY COLLEGE  
HEALTH AND WELLNESS CENTER  
CUP RE-SUBMITTAL  
OLYMPIA, WASHINGTON

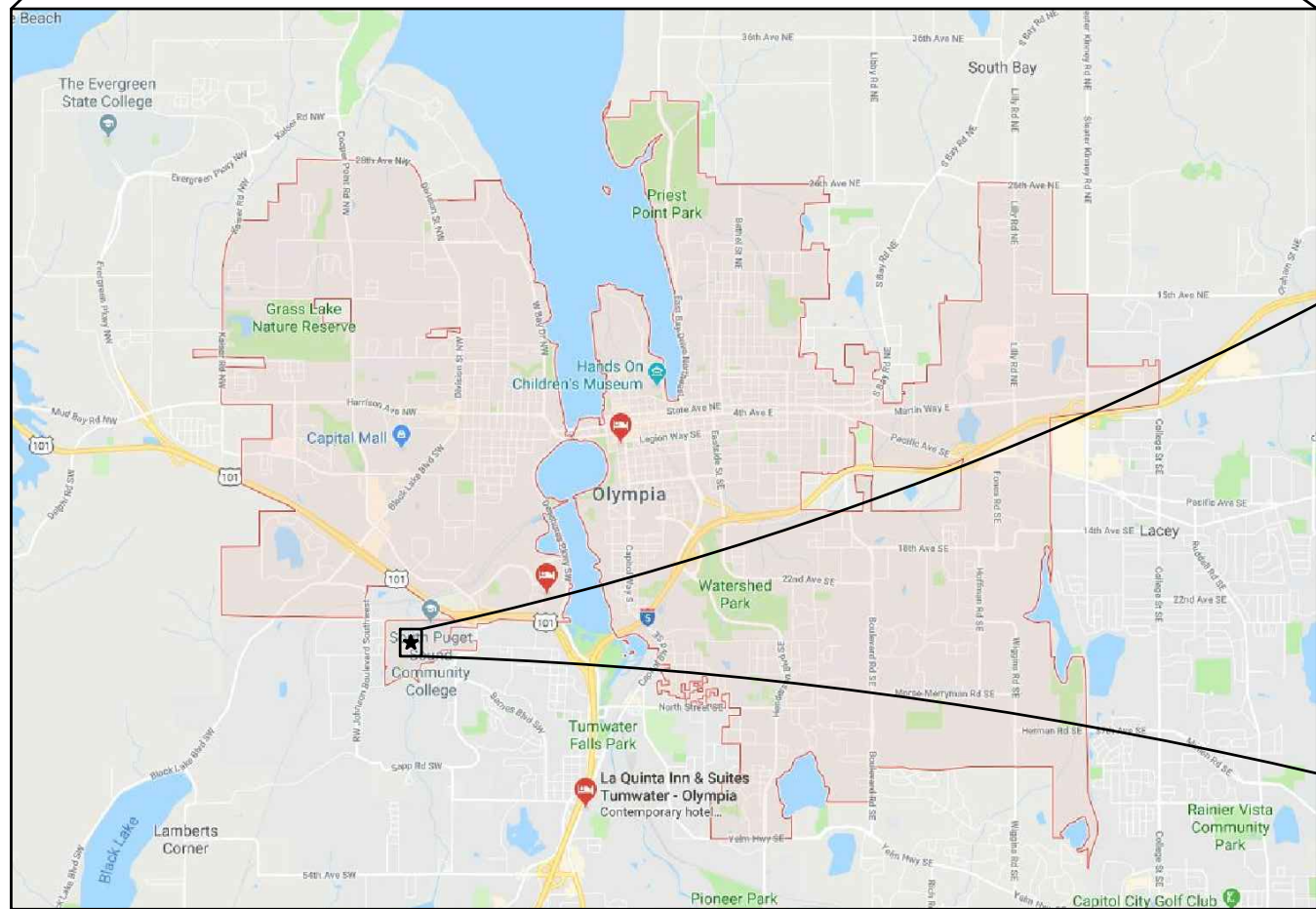
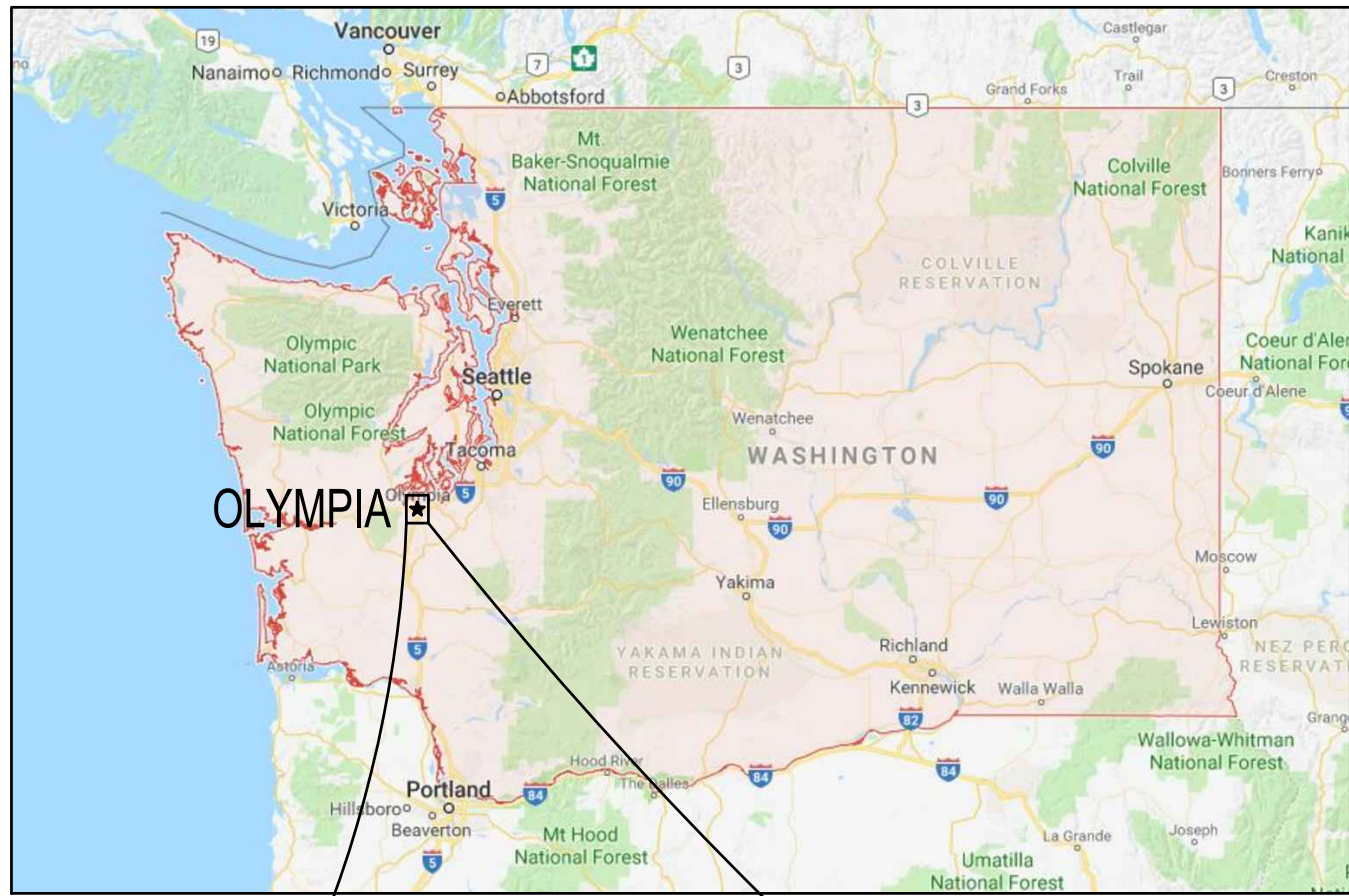

**OWNER / APPLICANT**  
SOUTH PUGET SOUND COMMUNITY COLLEGE  
2011 MOTTMAN RD SW  
OLYMPIA, WA 98512  
PHONE: 360.596.5227  
CONTACT: MARTY MATTES

**CONSULTANTS**  
SCJ ALLIANCE  
8730 TALLON LANE NE, SUITE 200  
LACEY, WA 98516  
PHONE: 360.352.1465  
CONTACT: ROSS JARVIS, P.E.

**ARCHITECT:**  
KMB ARCHITECTS  
906 COLUMBIA STREET SW, SUITE 400  
OLYMPIA, WA 98501  
PHONE: 360.292.1217  
CONTACT: JAMES HILL

**SURVEYOR:**  
KPFF  
612 WOODLAND SQUARE LOOP SE, SUITE 100  
LACEY, WA 98503  
PHONE: 360.292.7230  
CONTACT: JEROME CHAPMAN, P.L.S.

**GEOTECH:**  
GEOTECHNICALS  
1101 FAWCETT AVE #200  
TACOMA, WA 98402  
PHONE: 425.8616002  
CONTACT: KYLE SMITH

**SITE INFORMATION**  
PARCEL NUMBER: 1282810500  
ACRES: ±86.49

**SITE ADDRESS:**  
2011 MOTTMAN RD SW  
OLYMPIA, WA 98512

**UTILITIES**  
STORMWATER/SEWER/WATER/SOLID WASTE  
CITY OF OLYMPIA  
CITY UTILITIES  
9247TH AVENUE, STE A  
OLYMPIA, WA 98507  
PH: 360.753.8588  
EMERGENCY SERVICE: 360.753.8333

**ELECTRIC/NATURAL GAS:**  
PUGET SOUND ENERGY – PSE  
10865 NE 4TH ST  
BELLEVUE, WA 98009  
PH: 425.452.1234  
EMERGENCY SERVICE: 888.225.5773  
CONTACT: DAVE LESINKSI, ENGINEERING SPECIALIST,  
CONSTRUCTION SERVICES, PH: 253.476.6425

**CUSTOMER CONSTRUCTION:**  
3130 S 36TH ST  
TACOMA, WA 98409  
PH: 888.321.7779

**TELEPHONE:**  
CENTURY LINK  
711 CAPITOL WAY S, STE 307  
OLYMPIA, WA 98501  
PH: 360.754.5912  
CONTACT: WAYDE HOLMQUIST, SR DESIGN ENGINEER

**BASIS OF MERIDIAN:**  
NAD 83/91 – PER THURSTON COUNTY HIGH PRECISION  
NETWORK CONTROL POINTS 8204 AND 476AZ.

**DATUM:**  
NAVD 88 – PER THURSTON COUNTY HIGH PRECISION  
NETWORK CONTROL POINT 8204.

SHEET INDEX		
SHEET NO.	SHEET TITLE	SHEET DESCRIPTION
1	C-001	COVER SHEET
2	C-002	GENERAL NOTES
3	C-100	TOPOGRAPHIC SURVEY
4	C-101	TOPOGRAPHIC SURVEY
5	C-102	DEMOLITION AND TESC PLAN
6	C-103	SITE IMPROVEMENT PLAN
7	C-104	GRADING PLAN
8	C-105	DRAINAGE PLAN
9	C-501	DRAINAGE DETAILS
10	C-105	WATER AND SEWER PLAN

A PORTION OF SEC 28, T18N., R2W., W.M.  
OLYMPIA, WA



8730 TALLON LANE NE, SUITE 200, LACEY, WA 98516  
P: 360.352.1465 F: 360.352.1509  
SCJALLIANCE.COM

CALL BEFORE YOU DIG

THE CONTRACTOR SHALL BE FULLY RESPONSIBLE FOR THE LOCATION AND PROTECTION OF ALL EXISTING UTILITIES. THE CONTRACTOR SHALL VERIFY ALL UTILITY LOCATIONS PRIOR TO CONSTRUCTION BY CALLING THE UNDERGROUND LOCATE LINE AT (800) 424-5555 A MINIMUM OF 48 HOURS PRIOR TO ANY EXCAVATION.

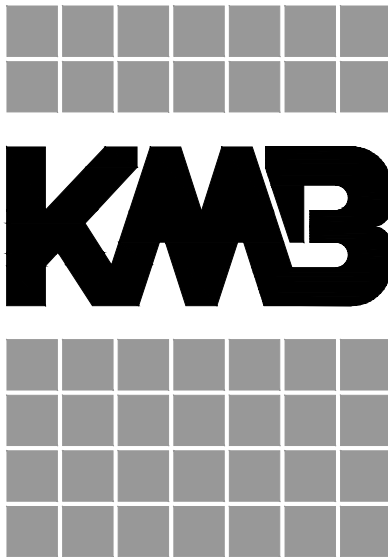

906 Columbia Street SW, Suite 400  
Olympia, Washington 98501  
360.352.8883

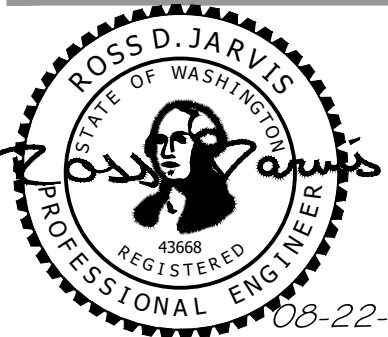

HEALTH AND WELLNESS CENTER RENOVATION AND ADDITION  
SOUTH PUGET SOUND COMMUNITY COLLEGE  
2011 MOTTMAN ROAD SW, OLYMPIA, WA 98512  
STATE PROJECT NO. 2018-111A

ORIGINAL SHEET SIZE = 24 x 36  
HALF SIZE REDUCTIONS = 11 x 17  
REVISIONS:

DATE:  
07/12/2018  
DESIGN DEVELOPMENT  
SHEET NO.

C-001  
COVER SHEET



LAST SAVE: mdyb-4d4b-0890-17-Ch01.dwg - August 22, 2018 (9:03 AM)  
PLOT: AutoCAD PDF (General Documentation).pc3 ARCH1.tu (sheet) (24.01 x 36.00 inches) SC-Full.ctb - August 22, 2018 (11:49 AM)

CITY OF OLYMPIA GENERAL NOTES:

REQUIRED GENERAL NOTES FOR ALL PROJECTS:

- ALL WORK AND MATERIALS SHALL BE COMPLETED IN ACCORDANCE WITH THE FOLLOWING:
  - THE CITY OF OLYMPIA'S 2017 ENGINEERING DESIGN AND DEVELOPMENT STANDARDS (EDDS).
  - THE MOST CURRENT "STANDARD SPECIFICATIONS FOR ROAD, BRIDGE, AND MUNICIPAL CONSTRUCTION" FROM THE WASHINGTON STATE DEPARTMENT OF TRANSPORTATION.
  - THE CITY OF OLYMPIA'S 2016 DRAINAGE AND EROSION CONTROL MANUAL, AND
  - THE CITY OF OLYMPIA SUPPLEMENTAL SPECIFICATIONS, THE CONTRACT SPECIFICATIONS AND SPECIALL PROVISIONS, AS APPLICABLE.
- A PRE-CONSTRUCTION CONFERENCE SHALL BE HELD WITH THE CITY PRIOR TO THE START OF CONSTRUCTION. ALL PRIVATE DEVELOPMENT (PERMITTED) PROJECTS MUST SCHEDULE THE PRE-CONSTRUCTION CONFERENCE USING THE CITY'S SMARTGOV PERMITTING SYSTEM.
- UNLESS NOTED OTHERWISE, UTILITIES SHOWN ON THE PLAN AND PROFILE ARE EXISTING, AND ARE LOCATED TO THE BEST INFORMATION AVAILABLE AT THE TIME OF PRINTING. THE CONTRACTOR SHALL VERIFY PRIOR TO CONSTRUCTION AND TAKE EXTRAORDINARY CARE WHEN EXCAVATING NEAR OR AROUND UTILITY CROSSINGS INCLUDING "HAND" EXCAVATION AND POT HOULING. IN THE EVENT OF A CONFLICT, THE CONTRACTOR SHALL COORDINATE WITH THE ENGINEER AND THE PRIVATE UTILITY TO RAISE, RELOCATE, OR LOWER THE CONFLICTING APPURTENANCES.
- THE CONTRACTOR SHALL BE FULLY RESPONSIBLE FOR THE LOCATION AND PROTECTION OF ALL EXISTING UTILITIES. THE CONTRACTOR SHALL VERIFY ALL UTILITY LOCATIONS PRIOR TO CONSTRUCTION BY CALLING 811, THE UNDERGROUND LOCATE LINE, A MINIMUM OF 48 HOURS (TWO WORKING DAYS) PRIOR TO ANY EXCAVATION. IT IS THE RESPONSIBILITY OF THE REQUESTER TO MAINTAIN THE MARKINGS AFTER THE INITIAL LOCATE IN ACCORDANCE WITH RCW 19.122.
- EROSION CONTROL SHALL BE IN ACCORDANCE WITH THE REQUIREMENTS OF THE CURRENT "DRAINAGE DESIGN AND EROSION CONTROL MANUAL FOR OLYMPIA" (DRAINAGE MANUAL).
- CONTRACTOR SHALL PROTECT ALL TREES AND VEGETATION THAT ARE NOT TO BE REMOVED AS DIRECTED BY THE ENGINEER.
- ALL DRAINAGE STRUCTURES, SANITARY MANHOLES, WATER METERS, WATER VALVES OR OTHER APPURTENANCES SHALL BE ADJUSTED TO FINAL GRADE BY THE CONTRACTOR UNLESS OTHERWISE NOTED ON THE PLANS.
- CONTRACTOR SHALL MAINTAIN FUNCTION OF ALL EXISTING UTILITIES DURING CONSTRUCTION, UNLESS OTHERWISE AGREED.
- CONTRACTOR SHALL TAKE CARE NOT TO DAMAGE EXISTING SIDEWALK AND ROAD SURFACES OUTSIDE OF THE PROJECT LIMITS. ALL DAMAGE OR UNDERMINING SHALL BE THE CONTRACTOR'S RESPONSIBILITY TO IMMEDIATELY REPAIR TO CITY STANDARDS AT THE CONTRACTOR'S EXPENSE.
- ALL EXISTING SIGNS THAT INTERFERE WITH CONSTRUCTION SHALL BE RELOCATED AS DIRECTED BY THE ENGINEER.
- ACCESS TO PRIVATE PROPERTY SHALL BE MAINTAINED AT ALL TIMES UNLESS PRIOR APPROVAL AND COORDINATION HAS OCCURRED.
- THE CONTRACTOR WILL BE RESPONSIBLE FOR ALL TRAFFIC CONTROL IN ACCORDANCE WITH THE U.S. DEPARTMENT OF TRANSPORTATION MANUAL ON UNIFORM TRAFFIC CONTROL DEVICES (MUTCD). PRIOR TO DISRUPTION OF ANY TRAFFIC, TRAFFIC CONTROL PLANS WILL BE PREPARED AND SUBMITTED TO THE CITY FOR APPROVAL. NO WORK WILL COMMENCE UNTIL ALL APPROVED TRAFFIC CONTROL IS IN PLACE.
- IT SHALL BE THE RESPONSIBILITY OF THE CONTRACTOR TO HAVE A COPY OF THE APPROVED CONSTRUCTION PLANS ON SITE AT ALL TIMES.
- ANY CHANGES TO THE DESIGN SHALL FIRST BE REVIEWED AND APPROVED BY THE ENGINEER.
- CITY OF OLYMPIA VERTICAL DATUM IS NAVD 88 AND SHALL BE USED FOR ALL VERTICAL CONTROL.

STANDARD NOTES FOR EROSION AND SEDIMENT CONTROL PLANS:

THE FOLLOWING STANDARD NOTES ARE REQUIRED FOR USE IN EROSION AND SEDIMENT CONTROL PLANS. PLANS SHOULD ALSO IDENTIFY WITH PHONE NUMBERS THE PERSON OR FIRM RESPONSIBLE FOR THE PREPARATION OF AND MAINTENANCE OF THE EROSION CONTROL PLAN.

- NO CONSTRUCTION RELATED ACTIVITY SHALL CONTRIBUTE TO THE DEGRADATION OF THE ENVIRONMENT, ALLOW MATERIAL TO ENTER SURFACE OR GROUND WATER, OR ALLOW PARTICULATE EMISSIONS TO THE ATMOSPHERE, WHICH EXCEED STATE OR FEDERAL STANDARDS. ANY ACTION THAT POTENTIALLY ALLOW A DISCHARGE TO STATE WATERS MUST HAVE PRIOR APPROVAL.
- A CERTIFIED EROSION AND SEDIMENT CONTROL LEAD (CESCL) IS REQUIRED FOR ALL CONSTRUCTION PROJECTS. THE NAMED PERSON OR FIRM SHALL BE ON-SITE OR ON-CALL AT ALL TIMES. FOR THIS SITE, THE PERSON/FIRM IS \_\_\_\_\_ AND THEIR OFFICE AND CELL TELEPHONE NUMBERS ARE \_\_\_\_\_
- APPROVAL OF THIS EROSION/SEDIMENTATION CONTROL (ESC) PLAN DOES NOT CONSTITUTE AN APPROVAL OF PERMANENT STREET OR DRAINAGE DESIGN (E.G. SIZE AND LOCATION OF ROADS, PIPES, RESTRICTORS, CHANNELS, RETENTION FACILITIES, UTILITIES, ETC.).
- THE IMPLEMENTATION OF THESE ESC PLANS AND THE CONSTRUCTION, MAINTENANCE, REPLACEMENT, AND UPGRADING OF THESE ESC FACILITIES IS THE RESPONSIBILITY OF THE APPLICANT/CONTRACTOR UNTIL ALL CONSTRUCTION IS COMPLETED AND APPROVED AND VEGETATION/LANDSCAPING IS ESTABLISHED.
- STORMWATER FACILITY INFILTRATIVE SURFACES SHALL BE PROTECTED FROM SEDIMENTATION AND COMPACTION THROUGHOUT CONSTRUCTION. NOTE THAT POST-CONSTRUCTION VERIFICATION TESTING IS REQUIRED FOR ALL STORMWATER INFILTRATION FACILITIES. STORMWATER INFILTRATION FACILITIES THAT FAIL TO PERFORM AS DESIGNED MUST BE RECONSTRUCTED OR EXPANDED TO SUBSTANTIALLY MEET THE DESIGNED PERFORMANCE.
- THE BOUNDARIES OF THE CLEARING LIMITS SHOWN ON THIS PLAN SHALL BE CLEARLY FLAGGED IN THE FIELD PRIOR TO CONSTRUCTION. DURING THE CONSTRUCTION PERIOD, NO DISTURBANCE BEYOND THE FLAGGED CLEARING LIMITS SHALL BE PERMITTED. THE FLAGGING SHALL BE MAINTAINED BY THE APPLICANT/CONTRACTOR FOR THE DURATION OF CONSTRUCTION.
- STABILIZED CONSTRUCTION ENTRANCES SHALL BE INSTALLED AT THE BEGINNING OF CONSTRUCTION AND MAINTAINED FOR THE DURATION OF THE PROJECT. ADDITIONAL MEASURES MAY BE REQUIRED TO INSURE THAT ALL PAVED AREAS ARE KEPT CLEAN FOR THE DURATION OF THE PROJECT.
- THE ESC FACILITIES SHOWN ON THIS PLAN MUST BE CONSTRUCTED IN CONJUNCTION WITH ALL CLEARING AND GRADING ACTIVITIES, AND IN SUCH A MANNER AS TO INSURE THAT SEDIMENT AND SEDIMENT LADEN WATER DO NOT ENTER THE DRAINAGE SYSTEM, ROADWAYS, OR VOLATE APPLICABLE WATER STANDARDS.
- THE ESC FACILITIES SHOWN ON THIS PLAN ARE THE MINIMUM REQUIREMENTS FOR ANTICIPATED SITE CONDITIONS. DURING THE CONSTRUCTION PERIOD, THESE ESC FACILITIES SHALL BE UPGRADED AS NEEDED FOR UNEXPECTED STORM EVENTS AND TO ENSURE THAT SEDIMENT AND SEDIMENT-LADEN WATER DO NOT LEAVE THE SITE.
- THE ESC FACILITIES SHALL BE INSPECTED DAILY BY THE APPLICANT/CONTRACTOR AND MAINTAINED AS NECESSARY TO ENSURE THEIR CONTINUED FUNCTIONING.
- THE ESC FACILITIES ON INACTIVE SITES SHALL BE INSPECTED AND MAINTAINED A MINIMUM OF ONCE A MONTH OR WITHIN 48 HOURS FOLLOWING A MAJOR STORM EVENT.
- AT NO TIME SHALL MORE THAN ONE FOOT OF SEDIMENT BE ALLOWED TO ACCUMULATE WITHIN A TRAPPED CATCH BASIN. ALL CATCH BASINS AND CONVEYANCE LINES SHALL BE HIGH VELOCITY CLEANED AND PRESSURE TESTED PRIOR TO PAVING. THE CLEANING OPERATION SHALL NOT FLUSH SEDIMENT LADEN WATER INTO THE DOWNSTREAM SYSTEM.
- ROADS SHALL BE CLEANED THOROUGHLY AS NEEDED TO PROTECT DOWNSTREAM WATER RESOURCES OR STORMWATER INFRASTRUCTURE. SEDIMENT SHALL BE REMOVED FROM ROADS BY SHOVELING OR PICKUP SWEEPING AND SHALL BE TRANSPORTED TO A CONTROLLED SEDIMENT DISPOSAL AREA.
- FROM OCTOBER 15 THROUGH APRIL 1, NO SOILS SHALL REMAIN EXPOSED AND UNWORKED FOR MORE THAN 2 DAYS. FROM APRIL 2 TO OCTOBER 14, NO SOILS SHALL REMAIN EXPOSED AND UNWORKED FOR MORE THAN 7 DAYS. SOILS SHALL BE STABILIZED AT THE END OF THE SHIFT BEFORE A HOLIDAY OR WEEKEND IF NEEDED BASED ON THE WEATHER FORECAST. LINEAR CONSTRUCTION ACTIVITIES, SUCH AS RIGHT-OF-WAY AND EASEMENT CLEARING, ROADWAY DEVELOPMENT, PIPELINES, AND TRENCHING FOR UTILITIES, SHALL COMPLY WITH THESE REQUIREMENTS. THESE STABILIZATION REQUIREMENTS APPLY TO ALL SOILS ON SITE, WHETHER AT FINAL GRADE OR NOT. THE LOCAL PERMITTING AUTHORITY MAY ADJUST THESE TIME LIMITS IF IT CAN BE SHOWN THAT A DEVELOPMENT SITE'S EROSION OR RUNOFF POTENTIAL JUSTIFIES A DIFFERENT STANDARD.
- FROM OCTOBER 15 THROUGH APRIL 1, CLEARING, GRADING, AND OTHER SOIL-DISTURBING ACTIVITIES SHALL ONLY BE PERMITTED IF SHOWN TO THE SATISFACTION OF THE LOCAL PERMITTING AUTHORITY THAT THE TRANSPORT OF SEDIMENT FROM THE CONSTRUCTION SITE TO RECEIVING WATERS WILL BE PREVENTED.
- SOIL STOCKPILES MUST BE STABILIZED AND PROTECTED WITH SEDIMENT-TRAPPING MEASURES.
- ALL POLLUTANTS, INCLUDING WASTE MATERIALS AND DEMOLITION DEBRIS, THAT OCCUR ON SITE DURING CONSTRUCTION SHALL BE HANDLED AND DISPOSED OF IN A MANNER THAT DOES NOT CAUSE CONTAMINATION OF STORMWATER. WOODY DEBRIS MAY BE CHOPPED AND SPREAD ON SITE.
- MAINTENANCE AND REPAIR OF HEAVY EQUIPMENT AND VEHICLES AND OTHER ACTIVITIES WHICH MAY RESULT IN DISCHARGE OR SPILLAGE OF POLLUTANTS TO THE GROUND OR INTO STORMWATER RUNOFF MUST BE CONDUCTED USING SPILL PREVENTION MEASURES, SUCH AS DRIP PANS. REPORT ALL SPILLS TO 911.
- WATER FROM MOST DEWATERING OPERATIONS SHALL BE DISCHARGED INTO A SEDIMENT TRAP OR POND. CLEAN, NOT-TURBID WATER MAY BE DISCHARGED TO STATE SURFACE WATERS, PROVIDED THE DISCHARGE DOES NOT CAUSE EROSION OR FLOODING. HIGHLY TURBID OR CONTAMINATED DEWATERING WATER FROM CONSTRUCTION EQUIPMENT OPERATION, CLAMSHELL DIGGING, CONCRETE TREMIE POUR, OR WORK INSIDE A COFFERDAM SHALL BE HANDLED SEPARATELY FROM STORMWATER AND PROPERLY DISPOSED.

STREET CONSTRUCTION:

- ALL CURB, CURB AND GUTTER, STREET GRADES, SIDEWALK GRADES, AND ANY OTHER VERTICAL AND/OR HORIZONTAL ALIGNMENT WILL BE STAKED BY ENGINEERING OR SURVEYING FIRMS CAPABLE OF PERFORMING SUCH WORK.
- ASPHALT CONCRETE PAVEMENT FOR WEARING COURSE WILL NOT BE PLACED ON ANY TRAVELED WAY BETWEEN OCTOBER 1ST AND APRIL 1ST WITHOUT WRITTEN APPROVAL FROM THE CITY ENGINEER.
- WHERE NEW ASPHALT JOINS EXISTING, THE EXISTING ASPHALT WILL BE CUT TO A NEAT VERTICAL EDGE AND TACKED WITH ASPHALT EMULSION TYPE CSS-1 IN ACCORDANCE WITH THE STANDARD SPECIFICATIONS.
- COMPACTION OF SUBGRADE, ROCK, AND ASPHALT WILL BE IN ACCORDANCE WITH THE STANDARD SPECIFICATIONS.
- ALL JOINT (CONTRACTION, CONSTRUCTION, ISOLATION, ETC.) LAYOUT PLANS SHALL BE APPROVED ONE WEEK BEFORE PLACING CONCRETE.
- FORM AND SUBGRADE INSPECTION BY THE CITY IS REQUIRED BEFORE PLACING CONCRETE. TWENTY-FOUR HOURS' NOTICE IS REQUIRED FOR FORM INSPECTION.
- TESTING AND SAMPLING FREQUENCIES WILL BE AS DESCRIBED IN THE CURRENT WSDOT STANDARD SPECIFICATIONS AND CHAPTER 4 OF THE EDDS.

SEC. 28, T18N., R2W., W.M.

STORMWATER CONSTRUCTION:

- ALL STORM CONVEYANCES AND RETENTION/DETENTION AREAS WILL BE STAKED FOR GRADE AND ALIGNMENT BY AN ENGINEERING OR SURVEYING FIRM CAPABLE OF PERFORMING SUCH WORK.
- SPECIAL STRUCTURES, OIL/WATER SEPARATORS, AND OUTLET CONTROLS WILL BE INSTALLED PURSUANT TO PLANS AND MANUFACTURER'S RECOMMENDATIONS.
- WHERE CONNECTIONS REQUIRE "FIELD VERIFICATIONS", CONNECTION POINTS WILL BE EXPOSED BY CONTRACTOR AND FITTINGS VERIFIED 48 HOURS PRIOR TO DISTRIBUTING SHUTDOWN NOTICES.
- ALL STORM LINES AND CATCH BASINS SHALL BE HIGH-VELOCITY CLEANED AND PRESSURE TESTED IN ACCORDANCE WITH DIVISION 7 OF THE STANDARD SPECIFICATIONS PRIOR TO PAVING IN CONFORMANCE WITH THE ABOVE-REFERENCED SPECIFICATIONS. HYDRANT FLUSHING OF LINES IS NOT AN ACCEPTABLE CLEANING METHOD.
- TESTING OF THE STORM PIPING WILL INCLUDE TELEVISION INSPECTION, COMPATIBLE WITH GRANITE XP SOFTWARE, AT THE CONTRACTOR'S EXPENSE. ADDITIONAL TELEVISIONS THAT IS DEEMED NECESSARY WILL ALSO BE AT THE CONTRACTOR'S EXPENSE. ALL TELEVISION INSPECTIONS SHALL BE COMPLETED IN THE MANNER AS REQUIRED BY THE PACP. IMMEDIATELY PRIOR TO TELEVISION INSPECTING, ENOUGH WATER WILL BE RUN DOWN THE LINE SO IT COMES OUT THE LOWER MANHOLE AND THE LINE IS FLUSHED CLEAN. ACCEPTANCE OF THE LINE WILL BE MADE AFTER THE TELEVISION INSPECTION TAPE HAS BEEN REVIEWED AND APPROVED BY THE INSPECTOR.
- ALL CATCH BASINS SHALL HAVE A CURB MARKER, ANTI-DUMPING DISC INSTALLED AS SPECIFIED IN THE EDDS.
- ALL SOLID ROUND CATCH BASIN COVERS SHALL BE CITY OF OLYMPIA DECORATIVE STANDARD (PER STANDARD DRAWING 5-12).
- ALL SURFACE STORM WATER FACILITIES SHALL HAVE INFORMATIONAL SIGNS INSTALLED ADJACENT TO STREETS, SIDEWALKS AND PATHS.

WATER MAIN CONSTRUCTION:

- ALL LINES WILL BE CHLORINATED AND TESTED IN CONFORMANCE AMERICAN WATER WORKS ASSOCIATION STANDARDS.
- ALL WATER MAINS WILL BE STAKED FOR GRADES AND ALIGNMENT BY AN ENGINEERING OR SURVEYING FIRM CAPABLE OF PERFORMING SUCH WORK. STAKING WILL BE MAINTAINED THROUGHOUT CONSTRUCTION.
- ALL WATER SYSTEM CONNECTIONS TO SERVE BUILDINGS OR PROPERTIES WITH DOMESTIC POTABLE WATER, FIRE SPRINKLER SYSTEMS, OR IRRIGATION SYSTEMS WILL COMPLY WITH THE MINIMUM BACKFLOW PREVENTION REQUIREMENTS AS ESTABLISHED BY THE WASHINGTON STATE DEPARTMENT OF HEALTH AND THE CITY OF OLYMPIA IN ITS CROSS CONNECTION PROGRAM.
- THE CITY REQUESTS TO WORKING DAYS WRITTEN NOTICE TO SCHEDULE SHUTDOWNS. THE WRITTEN NOTICE WILL BE COORDINATED WITH THE CITY INSPECTOR. THE CITY OF OLYMPIA DRINKING WATER OPERATIONS OR CITY INSPECTOR WILL PERFORM THE SHUTDOWN.
- AT ANY CONNECTION TO AN EXISTING LINE WHERE A NEW VALVE IS NOT INSTALLED, THE EXISTING VALVE MUST BE PRESSURE TESTED TO CITY STANDARDS BY THE CONTRACTOR PRIOR TO CONNECTION. IF AN EXISTING VALVE FAILS TO PASS THE TEST, THE CONTRACTOR WILL MAKE THE NECESSARY PROVISIONS TO TEST THE NEW LINE PRIOR TO CONNECTION TO THE EXISTING SYSTEM OR INSTALL A NEW VALVE.
- AT ANY WATER MAIN TAP TO EXISTING CITY MAINS WHERE THE CONTRACTOR ENCOUNTERS A COUPLING OR EXISTING ASSEMBLIES, THE CONTRACTOR WILL PROVIDE A MINIMUM OF 18 INCHES OF CLEARANCE FROM COUPLING OR ASSEMBLIES TO EDGE OF TAPPING SLEEVE.
- ANY WATER MAIN TAP OR CONNECTION WILL BE BLOCKED ACCORDING TO THE CITY OF OLYMPIA STANDARD DRAWINGS.
- ANY EXCAVATION THAT EXPOSES AN ASBESTOS CEMENT (AC) WATER MAIN OR THE CITY'S 36-INCH WATER TRANSMISSION MAIN SHALL BE BEDDED WITH CONTROLLED DENSITY FILL (CDF) PURSUANT TO THE WSDOT SPECIFICATIONS FOR CDF. AS AN OPTION THE CONTRACTOR MAY CHOOSE TO REPLACE THE AC PIPE AT ANY CROSSING WITH DUCTILE IRON PIPE BENCHED INTO BOTH TRENCH WALLS. THE CONTRACTOR WILL COORDINATE WITH THE CITY INSPECTOR TO HAVE A CITY OF OLYMPIA DRINKING WATER OPERATIONS STAFF MEMBER ON SITE BEFORE CONSTRUCTION BEGINS.
- BEFORE CUTTING OR REMOVING ANY EXISTING AC PIPE, THE CONTRACTOR WILL SUPPLY THE CITY OF OLYMPIA INSPECTOR A COPY OF THE WORKMAN'S CERTIFICATIONS TO WORK WITH AC PIPE. THE CONTRACTOR WILL CONFORM TO ALL REGULATIONS AND GUIDANCE RELATED TO ASBESTOS WORK PROVIDED BY THE OLYMPIC REGION CLEAN AIR AGENCY.

SANITARY SEWER CONSTRUCTION:

- IF CONSTRUCTION IS TO TAKE PLACE IN THE COUNTY RIGHT-OF-WAY, THE CONTRACTOR SHALL NOTIFY THE COUNTY AND OBTAIN ALL THE REQUIRED APPROVALS AND PERMITS.
- THE CITY OF OLYMPIA CONSTRUCTION INSPECTOR SHALL BE NOTIFIED A MINIMUM OF 48 HOURS (TWO WORKING DAYS) IN ADVANCE OF A TAP CONNECTION TO AN EXISTING MAIN. THE INSPECTOR SHALL BE PRESENT AT THE TIME OF THE TAP.
- ALL SEWER MAINS SHALL BE FIELD STAKED FOR GRADES AND ALIGNMENT BY A LICENSED ENGINEERING OR SURVEYING FIRM QUALIFIED TO PERFORM SUCH WORK. STAKING SHALL BE MAINTAINED THROUGHOUT CONSTRUCTION.
- WHEN TEMPORARY STREET PATCHES ARE ALLOWED BY THE CITY, COLD MIX ASPHALT SHALL BE PLACED AND COMPACTED TO A MAXIMUM DEPTH OF 2 INCHES. CONTRACTOR SHALL BE RESPONSIBLE FOR MAINTENANCE AS REQUIRED BY THE CITY.
- AFTER BACKFILLING, BUT PRIOR TO PAVING, ALL MAINS AND APPURTENANCES SHALL BE INSPECTED AND APPROVED BY THE CITY OF OLYMPIA CONSTRUCTION INSPECTOR. APPROVAL DOES NOT CONSTITUTE FINAL ACCEPTANCE OF THE SEWER LINE. THE CONTRACTOR SHALL RETAIN THE RESPONSIBILITY TO REPAIR ALL DEFICIENCIES AND FAILURES REVEALED DURING ALL REQUIRED TESTING FOR ACCEPTANCE AND THROUGH THE DURATION OF THE WARRANTY. IT SHALL BE THE CONTRACTOR'S RESPONSIBILITY TO NOTIFY THE CITY OF OLYMPIA FOR THE REQUIRED INSPECTIONS. ANY MAIN OR APPURTENANCE BACKFILLED PRIOR TO INSPECTION SHALL BE RE-EXCAVATED FOR INSPECTION.
- ALL LINES WILL BE HIGH-VELOCITY CLEANED AND SUBJECTED TO A LOW-PRESSURE AIR TEST PURSUANT TO CURRENT WSDOT STANDARD SPECIFICATIONS AFTER BACKFILLING, BUT PRIOR TO PAVING. HYDRANT FLUSHING OF LINES IS NOT AN ACCEPTABLE CLEANING METHOD.
- TESTING OF THE SANITARY SEWER MAIN WILL INCLUDE TELEVISION INSPECTION, COMPATIBLE WITH GRANITE XP SOFTWARE, AT THE CONTRACTOR'S EXPENSE. ADDITIONAL TELEVISIONS THAT IS DEEMED NECESSARY WILL ALSO BE AT THE CONTRACTOR'S EXPENSE. ALL TELEVISION INSPECTIONS SHALL BE COMPLETED IN THE MANNER REQUIRED BY THE PACP. IMMEDIATELY PRIOR TO TELEVISION INSPECTION, ENOUGH WATER WILL BE RUN DOWN THE LINE SO IT COMES OUT THE LOWER MANHOLE AND THE LINE IS FLUSHED CLEAN. ACCEPTANCE OF THE LINE WILL BE MADE AFTER THE TELEVISION INSPECTION TAPE HAS BEEN REVIEWED AND APPROVED BY THE CITY INSPECTOR.
- A TEST OF ALL MANHOLES IN ACCORDANCE WITH OLYMPIA STANDARD IS ALSO REQUIRED. TESTING WILL TAKE PLACE AFTER ALL UNDERGROUND UTILITIES ARE INSTALLED AND COMPACTION OF THE ROADWAY SUBGRADE IS COMPLETED.
- IN ADDITION, THE FOLLOWING SPECIFIC NOTES PERTAINING TO STEP SYSTEMS AND LIFT STATIONS AND FORCE MAINS WILL BE INCLUDED WHEN THESE UTILITIES ARE PART OF THE PROJECT.



8730 TALLON LANE NE, SUITE 200, LACEY, WA 98516  
P: 360.352.1465 F: 360.352.1509  
SCJALLIANCE.COM

CALL BEFORE YOU DIG

THE CONTRACTOR SHALL BE FULLY RESPONSIBLE FOR THE LOCATION AND PROTECTION OF ALL EXISTING UTILITIES. THE CONTRACTOR SHALL VERIFY ALL UTILITY LOCATIONS PRIOR TO CONSTRUCTION BY CALLING THE UNDERGROUND LOCATE LINE AT (800) 424-5555 A MINIMUM OF 48 HOURS PRIOR TO ANY EXCAVATION.

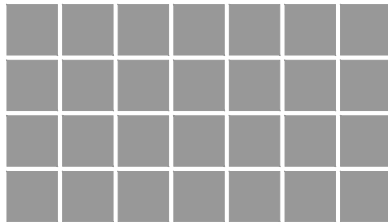

architects

906 Columbia Street SW, Suite 400  
Olympia, Washington 98501  
360.352.8883

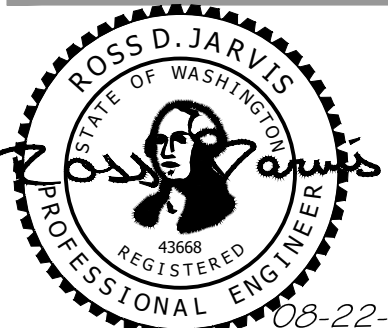

08-22-2018  
KMB Project # E1626

HEALTH AND WELLNESS CENTER RENOVATION AND ADDITION  
SOUTH PUGET SOUND COMMUNITY COLLEGE  
2011 MOTTMAN ROAD SW, OLYMPIA, WA 98512  
STATE PROJECT NO. 2018-111A

ORIGINAL SHEET SIZE = 24 x 36  
HALF SIZE REDUCTIONS = 11 x 17  
REVISIONS:

DATE:  
07/12/2018  
DESIGN DEVELOPMENT  
SHEET NO.

C-002

GENERAL NOTES

PERMIT STAMP

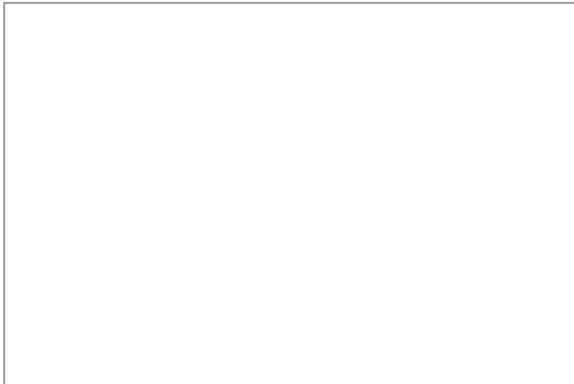



TOPOGRAPHIC SURVEY  
IN  
SECTION 28, TOWNSHIP 18N, RANGE 2 WEST, W.M.

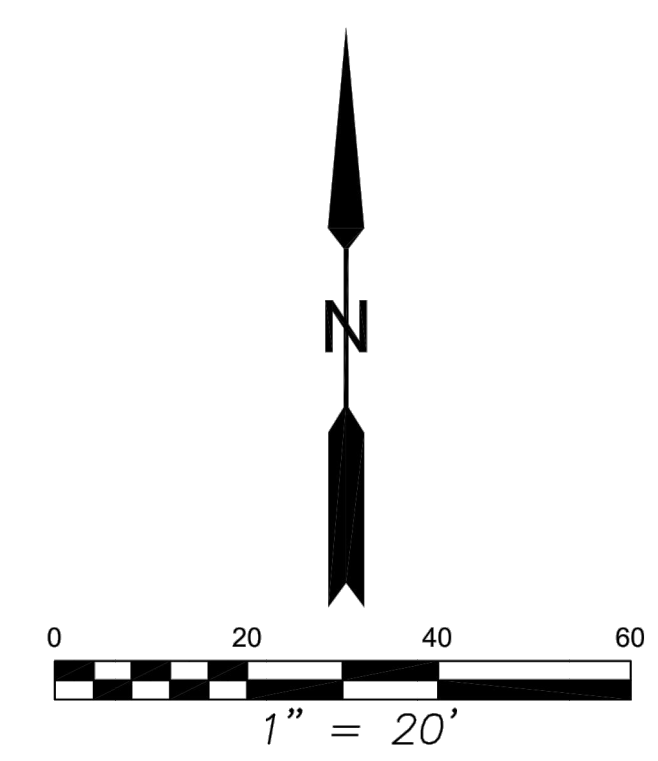
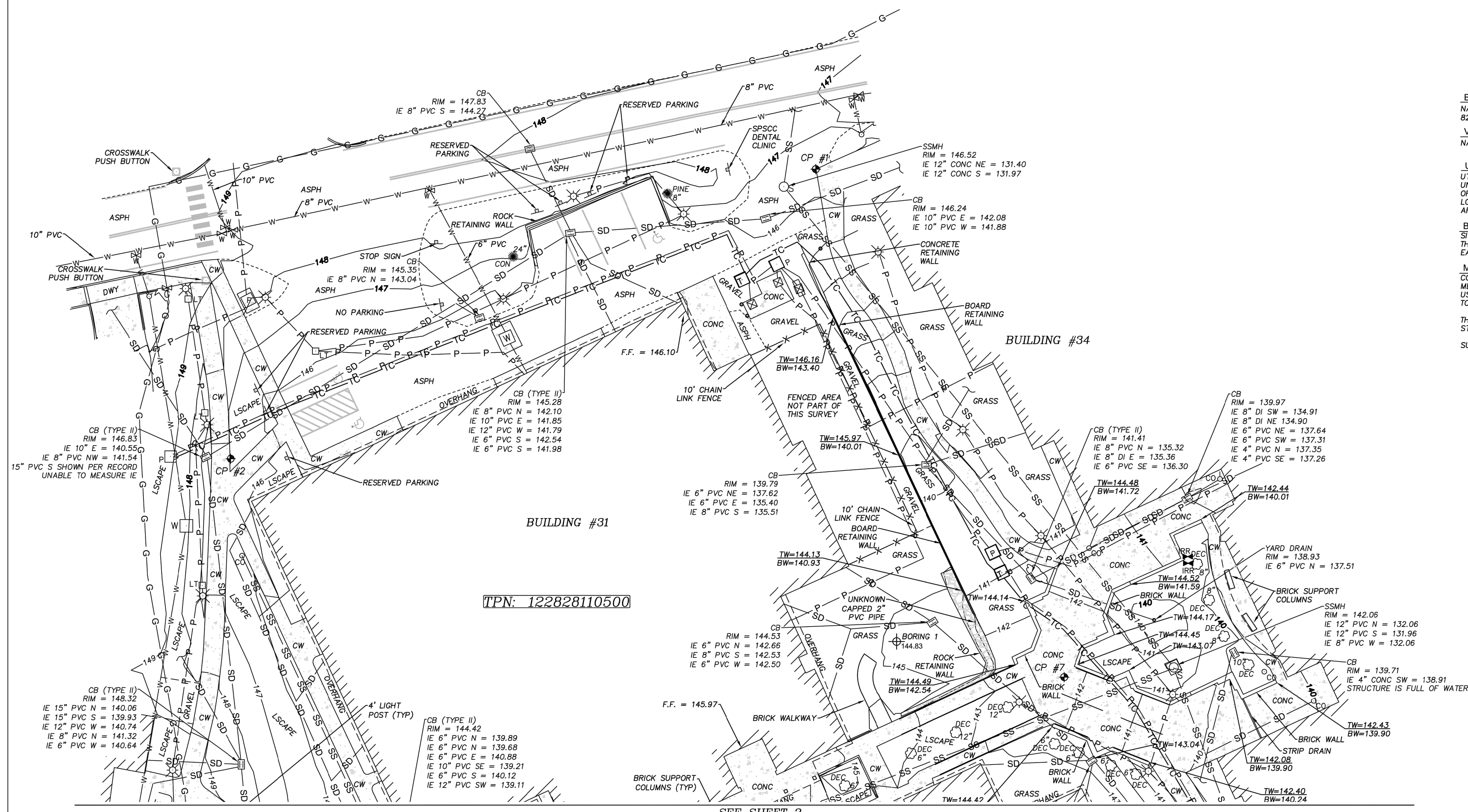

**BASIS OF MERIDIAN:**  
NAD 83/91 - PER THURSTON COUNTY HIGH PRECISION NETWORK CONTROL POINTS 8204 AND 476AZ.

**VERTICAL DATUM:**  
NAVD 88 - PER THURSTON COUNTY HIGH PRECISION NETWORK CONTROL POINT 8204.

**UTILITY NOTE:**  
UTILITIES SHOWN HEREON ARE PER KPFF SITE SURVEY OF SURFACE FEATURES, UNDERGROUND LOCATES PERFORMED BY KPFF, AND AS-BUILTS ON FILE AT THE OFFICE OF KPFF AND SHOULD BE CONSIDERED APPROXIMATE ONLY. STEPS TO CONFIRM LOCATION PRIOR TO CONSTRUCTION SHOULD BE TAKEN. ROOF DRAIN CONNECTIONS ARE SHOWN PER RECORD.

**BOUNDARY NOTE:**  
SITE IS CONTAINED WITHIN THE SOUTH PUGET SOUND COMMUNITY COLLEGE OWNERSHIP. THIS SURVEY MAKES NO DETERMINATION RELATING TO BOUNDARY, RIGHT OF WAY, OR EASEMENTS THAT MAY AFFECT THE SITE AREA.

**METHOD OF SURVEY:**  
CONTROL SURVEY PERFORMED USING TOPCON GR-S GPS RECEIVERS USING RTK METHODS. CONVENTIONAL FIELD TRAVERSE AND TOPOGRAPHIC SURVEY PERFORMED USING CONVENTIONAL GROUND METHODS WITH THE USE OF A TOPCON PS101 ROBOTIC TOTAL STATION.

THE WORK PERFORMED DURING THE COURSE OF THIS SURVEY MEETS OR EXCEEDS THE STANDARDS AS SET FORTH IN WAC 332-130-090.

SURVEY COMPLETED IN JULY OF 2018.

- LEGEND**
- CONTROL POINT
  - POWER VAULT
  - POWER TRANSFORMER
  - LIGHT JUNCTION BOX
  - LUMINAIRE
  - WALKWAY LIGHT
  - TELEPHONE VAULT
  - FIRE HYDRANT
  - WATER VAULT
  - WATER METER
  - IRRIGATION VALVE
  - GAS VALVE
  - GAS METER
  - SANITARY SEWER MANHOLE
  - SEWER CLEANOUT
  - CATCH BASIN
  - STORM CLEANOUT
  - SIGN AS NOTED
  - BOLLARD
  - BORING LOCATION
  - SPECIES SIZE
  - CONIFER
  - DECIDUOUS
  - LARGE BUSH
  - GAS LINE
  - WATER LINE
  - SANITARY SEWER
  - STORM DRAIN
  - UNDERGROUND POWER
  - UNDERGROUND COMMUNICATIONS
  - EDGE OF PAVEMENT
  - FENCE AS NOTED
  - BUILDING HATCH
  - ROCK HATCH
  - CONCRETE HATCH

CONTROL POINTS			
POINT #	NORTHING	EASTING	ELEVATION DESCRIPTION
1	625439.214	1033496.127	146.66 MAG NAIL
2	625347.580	1033311.076	146.51 HUB/MAG
7	625278.495	1033574.699	142.43 MAG NAIL

**SURVEYORS CERTIFICATE**

I HEREBY CERTIFY THAT THIS MAP IS AN ACCURATE REPRESENTATION MADE BY ME OR UNDER MY DIRECTION.

DATE \_\_\_\_\_

JEROME F. CHAPMAN  
PROFESSIONAL LAND SURVEYOR  
CERTIFICATE NO. 45779

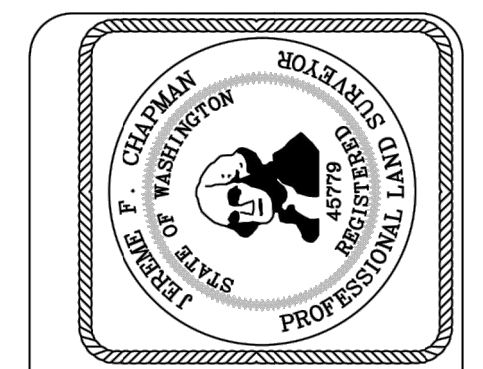

612 Woodland Square Loop SE,  
Suite 100  
Lacey, WA 98503  
360.292.7230  
www.kpff.com

**kpff**

**TOPOGRAPHIC SURVEY**  
OF A PORTION OF  
SEC. 28 TWP 18 N, R 2 W, W.M.,  
AT THE REQUEST OF  
DEPT. OF ENTERPRISE SERVICES

SCALE: 1" = 20'  
JOB: 81800001  
DATE: 7/26/2018  
SHEET 1 OF 2



TOPOGRAPHIC SURVEY  
IN  
SECTION 28, TOWNSHIP 18N, RANGE 2 WEST, W.M.

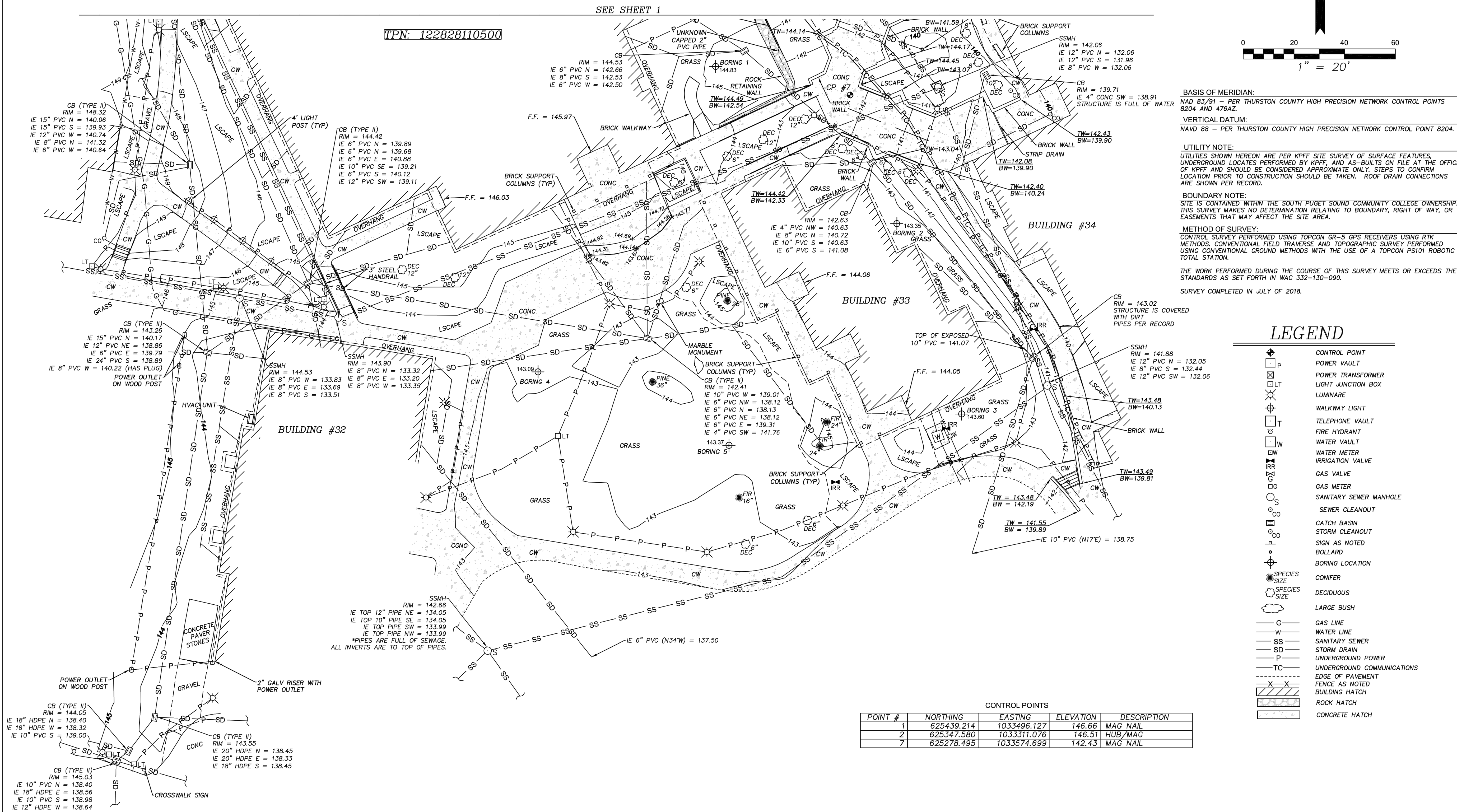

SURVEYORS CERTIFICATE

I HEREBY CERTIFY THAT THIS MAP IS AN ACCURATE REPRESENTATION MADE BY ME OR UNDER MY DIRECTION.

DATE

JEROME F. CHAPMAN

PROFESSIONAL LAND SURVEYOR

CERTIFICATE NO. 45779

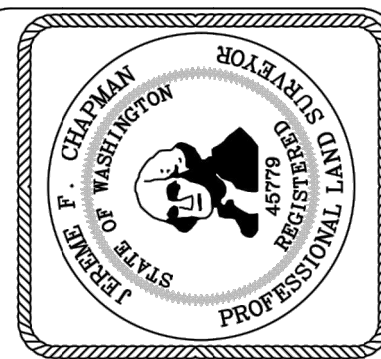

612 Woodland Square Loop SE,  
Suite 100  
Lacey, WA 98503  
360.292.7230  
www.kpff.com

kpff

TOPOGRAPHIC SURVEY  
OF A PORTION OF  
SEC. 28 TWP 18 N, R 2 W, W.M.,  
AT THE REQUEST OF  
DEPT. OF ENTERPRISE SERVICES

SCALE: 1" = 20'  
JOB: 81800001  
DATE: 7/26/2018  
SHEET 2 OF 2



LAST SAVE: rcs-jarvis\_080317.eco1.dwg - August 22, 2018 (11:29 AM)  
PLOT: AutoCAD PDF (General Documentation) p03, ARCH LUL Head D (24.00 x 36.00 inches), SC-Fullch - August 22, 2018 (11:49 AM)

#### TREE PROTECTION FENCE INSTALLATION:

1. CONTACT PROJECT FORESTER TO IDENTIFY LOCATION FOR TREE PROTECTION FENCE ON SITE
2. CONTRACTOR TO INSTALL TREE PROTECTION FENCE
3. PROJECT FORESTER INSPECTS LOCATION AND INSTALLATION OF TREE FENCE AND SENDS CITY OF OLYMPIA FORESTER INSPECTION NOTICE OF APPROVAL
4. CITY FORESTER NOTIFIES INSPECTOR THE PRE-CONSTRUCTION CONFERENCE MAY BE SCHEDULED
5. CONTACT PROJECT FORESTER TO ATTEND THE PRE-CONSTRUCTION CONFERENCE TO DISCUSS TREE PROTECTION ISSUES
6. REMOVAL OF TREES AND GRADING MAY BEGIN WITHIN THE CLEARING LIMITS OF THE CONSTRUCTION AREA
7. MAINTAIN ALL TREE PROTECTION FENCES THROUGHOUT CONSTRUCTION
8. IF ANY UNPLANNED CONSTRUCTION ACTIVITY WILL AFFECT A SAVE TREE, CONTACT PROJECT FORESTER PRIOR TO THE IMPACT. PROJECT FORESTER ASSESSES THE PROPOSED IMPACT AND RECOMMENDS CULTURAL CARE, MITIGATION, OR REMOVAL. PROJECT FORESTER SENDS EMAIL TO CITY OF OLYMPIA FORESTER FOR FINAL APPROVAL

#### CALL BEFORE YOU DIG

THE CONTRACTOR SHALL BE FULLY RESPONSIBLE FOR THE LOCATION AND PROTECTION OF ALL EXISTING UTILITIES. THE CONTRACTOR SHALL VERIFY ALL UTILITY LOCATIONS PRIOR TO CONSTRUCTION BY CALLING THE UNDERGROUND LOCATE LINE AT (800) 424-5555 A MINIMUM OF 48 HOURS PRIOR TO ANY EXCAVATION.



8730 TALLON LANE NE, SUITE 200, LACEY, WA 98516  
P: 360.352.1465 F: 360.352.1509  
SCJALLIANCE.COM

SEC. 28, T18N., R2W., W.M.

BUILDING #34

BUILDING #31

TPN: 122828110500

BUILDING #33

BUILDING #34

BUILDING #32

#### LEGEND

- STABILIZED CONSTRUCTION ENTRANCE
- INLET SEDIMENT PROTECTION
- SILT FENCE
- TREE PROTECTION FENCE
- SAWCUT
- EXISTING CONCRETE/SIDEWALK/CURB AND BASE TO BE REMOVED
- EXISTING ASPHALT TO BE REMOVED
- EXISTING TREE TO BE REMOVED
- REMOVE EXISTING STORM LINE AND BACKFILL TO 95%
- REMOVE EXISTING POWER LINE AND BACKFILL TO 95%
- REMOVE EXISTING SEWER LINE AND BACKFILL TO 95%
- REMOVE EXISTING WATER LINE AND BACKFILL TO 95%

#### EROSION CONTROL NOTES:

1. SILT FENCE
2. INLET PROTECTION
3. CONSTRUCTION ENTRANCE
4. TREE PROTECTION FENCE

#### DEMOLITION NOTES:

1. SAWCUT. CONCRETE TO BE SAWCUT TO NEAREST JOINT.
2. EXISTING BUILDING AND FOUNDATION TO BE DEMOLISHED
3. REMOVE STORM STRUCTURE AND BACKFILL TO 95% COMPACTION
4. REMOVE LIGHT STANDARD, J-BOXES, AND BACKFILL TO 95% COMPACTION
5. REMOVE ±2'-3" BRICK WALL
6. PROTECT EXISTING HANDRAIL
7. REMOVE AND DISPOSE OF VEGETATION (CLEAR AND GRUB), TO BE COORDINATED WITH OWNER
8. REMOVE SEWER LINE
9. RELOCATE IRRIGATION METER, SEE LANDSCAPE PLANS FOR LOCATION. WATER SERVICE SHALL BE ABANDONED AT THE MAIN AND CAPPED. ABANDONMENT AND INSTALLATION OF NEW METER TO BE PERFORMED BY THE CITY OF OLYMPIA AT THE COST TO THE DEVELOPER
10. PROTECT EXISTING UTILITY UNLESS NOTED OTHERWISE
11. PROTECT MANHOLE, ADJUST TO GRADE AS NECESSARY
12. PROTECT TELEPHONE VAULT, ADJUST TO GRADE
13. PROTECT POWER VAULT, ADJUST TO GRADE
14. PROTECT WOOD RETAINING WALL
15. PROTECT CATCH BASIN, ADJUST TO GRADE AS NECESSARY
16. REMOVE DOMESTIC METER, TO BE PERFORMED BY THE CITY OF OLYMPIA AT THE COST TO THE DEVELOPER
17. REMOVE ROCK WALL AS NECESSARY FOR ADA RAMP CONSTRUCTION
18. REMOVE AND REPLACE RESERVED PARKING SIGN
19. PROTECT WATER VAULT
20. PROTECT COMMUNICATIONS TRENCH
21. REMOVE BRICK WALKWAY
22. REMOVE TREE STUMP
23. ABANDON STORM LINE IN PLACE
24. PROTECT POND FROM SEDIMENTS THROUGHOUT THE DURATION OF THE PROJECT
25. ABANDON SEWER LINE IN PLACE
26. THE EXISTING FIRE LANE WILL BE IMPACTED WITH UTILITY TRENCHING. ALL UTILITY TRENCHING SHALL BE DONE AT THE SAME TIME TO MINIMIZE THE TIME IT IS IMPACTED
27. APPROX. 60 L.F. OF 6" WATER LINE TO BE REMOVED. REMAINING LENGTH OF 6" WATER LINE TO WATER MAIN IS NO LONGER NEEDED AND WILL BE ABANDONED IN PLACE

PERMIT STAMP

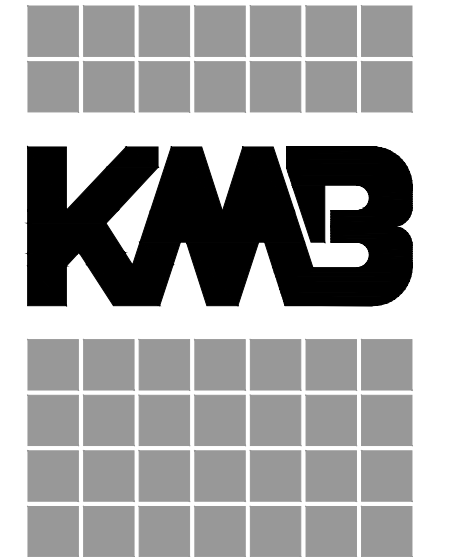

architects

906 Columbia Street SW, Suite 400  
Olympia, Washington 98501  
360.352.8883

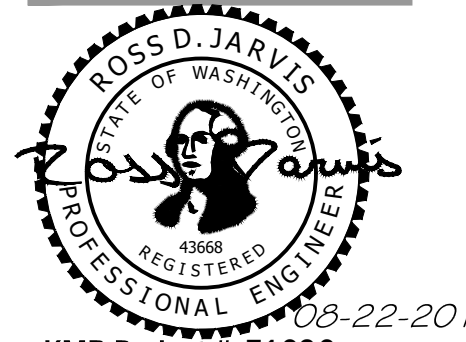

KMB Project # E1626

HEALTH AND WELLNESS CENTER RENOVATION AND ADDITION  
SOUTH PUGET SOUND COMMUNITY COLLEGE  
2011 MOTTMAN ROAD SW, OLYMPIA, WA 98512  
STATE PROJECT NO. 2018-111A

ORIGINAL SHEET SIZE = 24 x 36  
HALF SIZE REDUCTIONS = 11 x 17  
REVISIONS:

DATE: 07/12/2018  
DESIGN DEVELOPMENT  
SHEET NO.

C-102

DEMOLITION AND  
TESC PLAN



LAST SAVE: mdyb\chb\ 0830.17 SP.01.dwg August 22, 2018 (11:18 AM)  
PLOT: AutoCAD PDF (General Documentation).pc3 ARCH Full Bleed D (24.00 x 36.00 inches) SC-Full.ctb - August 22, 2018 (11:50 AM)

CALL BEFORE YOU DIG

THE CONTRACTOR SHALL BE FULLY RESPONSIBLE FOR THE LOCATION AND PROTECTION OF ALL EXISTING UTILITIES. THE CONTRACTOR SHALL VERIFY ALL UTILITY LOCATIONS PRIOR TO CONSTRUCTION BY CALLING THE UNDERGROUND LOCATE LINE AT (800) 424-5555 A MINIMUM OF 48 HOURS PRIOR TO ANY EXCAVATION.

**SCJ ALLIANCE**  
CONSULTING SERVICES

8730 TALLON LANE NE, SUITE 200, LACEY, WA 98516  
P: 360.352.1465 F: 360.352.1509  
SCJALLIANCE.COM

SEC. 28, T18N., R2W., W.M.

BUILDING #34

BUILDING #31

TPN: 122828110500

BUILDING #34

BUILDING #31 EXPANSION

BUILDING #32

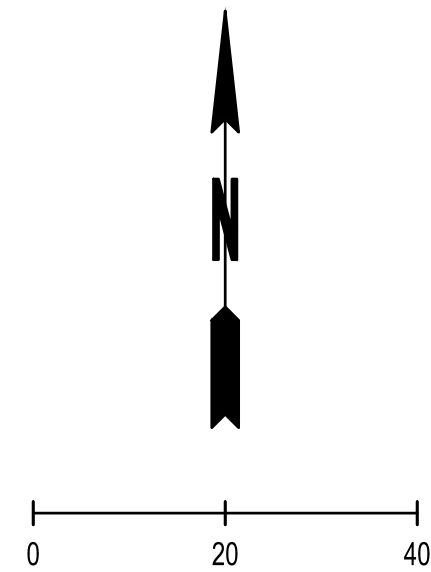

LEGEND

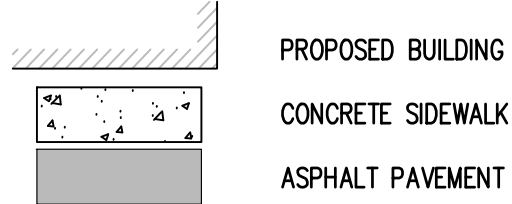

XX CONSTRUCTION NOTES:

1. SIDEWALK ENTRANCE WITH RAMP AND LANDING (SEE ENLARGEMENT ON SHEET CG-01)
2. STEPS TO BE CONSTRUCTED PER ARCHITECTURAL PLANS
3. ADA RAMP HANDRAIL PER ARCHITECTECTURAL PLANS
4. ACCESSIBILITY SYMBOL, 4" WIDE STRIPING PAINT 2 COATS WHITE W/ 7 MIL DFT PER COAT
5. REPLACE RESERVED PARKING SIGN
6. EXISTING SOLID WASTE RECEPTACLE TO REMAIN
7. ADD. ALTERNATE #1: COVERED WALKWAY
8. BICYCLE RACK, PER ARCHITECTURAL PLANS
9. 4" WIDE STRIPING PAINT 2 COATS TRAFFIC WHITE WITH 7 MIL DFT PER COAT
10. EXISTING ELECTRICAL TRANSFORMERS TO REMAIN
11. PROPOSED UTILITY VAULT, SEE ELECTRICAL PLANS
12. PROPOSED FLOOR MOUNTED MECHANICAL UNITS, SEE MECHANICAL PLANS

PERMIT STAMP

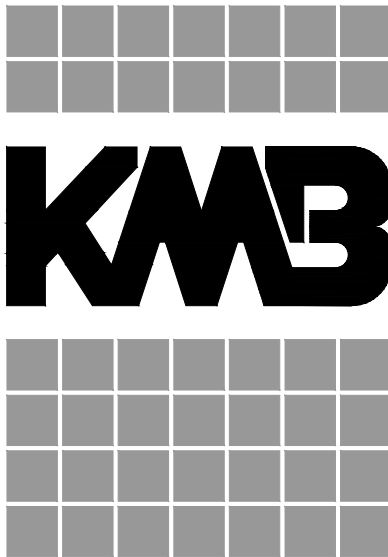

**architects**

906 Columbia Street SW, Suite 400  
Olympia, Washington 98501  
360.352.8883

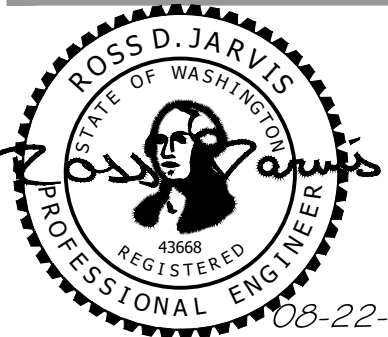

KMB Project # E1626

**HEALTH AND WELLNESS CENTER RENOVATION AND ADDITION**  
**SOUTH PUGET SOUND COMMUNITY COLLEGE**  
2011 MOTTMAN ROAD SW, OLYMPIA, WA 98512  
STATE PROJECT NO. 2018-111A

ORIGINAL SHEET SIZE = 24 x 36  
HALF SIZE REDUCTIONS = 11 x 17

REVISIONS:

DATE:  
07/12/2018

DESIGN DEVELOPMENT

SHEET NO.

**C-103**

SITE IMPROVEMENT  
PLAN



LAST SAVE: 08/07/2018 11:50 AM  
PLOT: AutoCAD PDF (General Documentation) pcd, ARCH Full bleed D (24.00 x 36.00 inches), SC Full ch - August 22, 2018 (11:50 AM)

### CALL BEFORE YOU DIG

THE CONTRACTOR SHALL BE FULLY RESPONSIBLE FOR THE LOCATION AND PROTECTION OF ALL EXISTING UTILITIES. THE CONTRACTOR SHALL VERIFY ALL UTILITY LOCATIONS PRIOR TO CONSTRUCTION BY CALLING THE UNDERGROUND LOCATE LINE AT (800) 424-5555 A MINIMUM OF 48 HOURS PRIOR TO ANY EXCAVATION.

**SCJ ALLIANCE**  
CONSULTING SERVICES

8730 TALLON LANE NE, SUITE 200, LACEY, WA 98516  
P: 360.352.1465 F: 360.352.1509  
SCJALLIANCE.COM

SEC. 28, T18N., R2W., W.M.

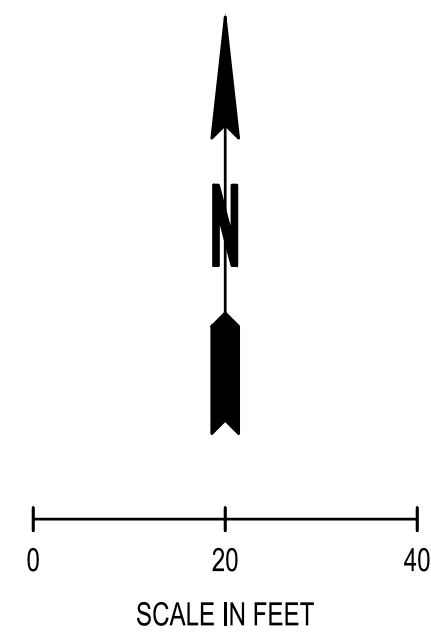

### LEGEND

- XX--- EXISTING MAJOR CONTOUR
- XX--- EXISTING MINOR CONTOUR
- XX--- PROPOSED MAJOR CONTOUR
- XX--- PROPOSED MINOR CONTOUR
- GRADE BREAK
- XXX.XX SPOT ELEVATION
- XX SLOPE LABEL

### GRADING QUANTITIES

CUT: 155 C.Y.  
FILL: 238 C.Y.  
NET: 83 C.Y. (FILL)

### ENLARGEMENT #1

SCALE: 1"=10'

PERMIT STAMP

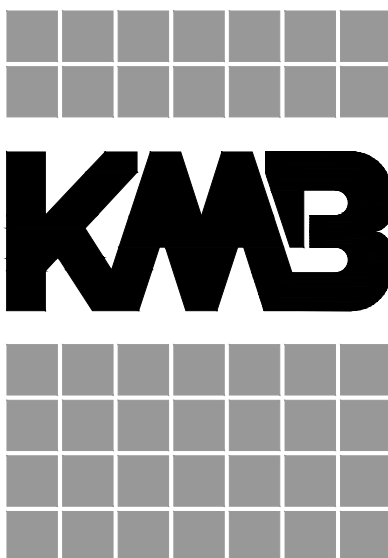

**architects**

906 Columbia Street SW, Suite 400  
Olympia, Washington 98501  
360.352.8883

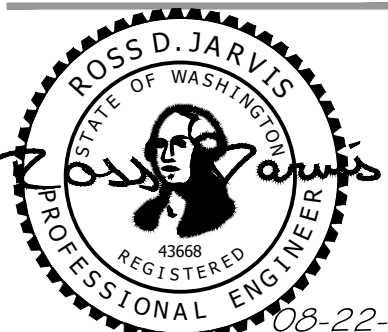

KMB Project # E1626

**HEALTH AND WELLNESS CENTER RENOVATION AND ADDITION**  
**SOUTH PUGET SOUND COMMUNITY COLLEGE**  
2011 MOTTMAN ROAD SW, OLYMPIA, WA 98512  
STATE PROJECT NO. 2018-111A

ORIGINAL SHEET SIZE = 24 x 36  
HALF SIZE REDUCTIONS = 11 x 17  
REVISIONS:

DATE: 07/12/2018  
DESIGN DEVELOPMENT  
SHEET NO.

**C-104**

GRADING PLAN



LAST SAVE: mdyw\cshb\08017 SD 01.dwg - August 22, 2018 (9:09 AM)  
PLOT: AutoCAD PDF (General Documentation).pc3, ARCH Full Sheet D (24.00 x 36.00 inches), SC Fullch - August 22, 2018 (11:50 AM)

### CALL BEFORE YOU DIG

THE CONTRACTOR SHALL BE FULLY RESPONSIBLE FOR THE LOCATION AND PROTECTION OF ALL EXISTING UTILITIES. THE CONTRACTOR SHALL VERIFY ALL UTILITY LOCATIONS PRIOR TO CONSTRUCTION BY CALLING THE UNDERGROUND LOCATE LINE AT (800) 424-5555 A MINIMUM OF 48 HOURS PRIOR TO ANY EXCAVATION.



8730 TALLON LANE NE, SUITE 200, LACEY, WA 98516  
P: 360.352.1465 F: 360.352.1509  
SCJALLIANCE.COM

SEC. 28, T18N., R2W., W.M.

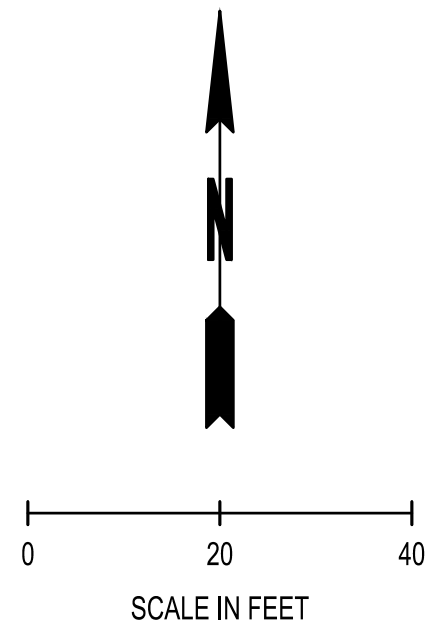

### LEGEND

- XX--- EXISTING CONTOURS (MAJOR/MINOR)
- XX--- PROPOSED CONTOURS (MAJOR/MINOR)
- SD--- EXISTING STORM LINE
- EXISTING CATCH BASIN
- SD STORM DRAIN PIPE (ADS N-12 UNLESS NOTED OTHERWISE)
- FD 4" PERFORATED PVC SDR 35 FOOTING DRAIN @ MIN. 0.5% SLOPE, SEE DETAIL ON SHEET SD-02
- RD 6" PVC SDR 35 ROOF DRAIN, TIGHTLINE @ 0.5% MIN. SLOPES, SEE DETAIL ON SHEET SD-02
- CATCH BASIN TYPE 1 PER WSDOT STD. PLAN B-5.20.01 WITH VANED GRATE UNLESS NOTED OTHERWISE
- QUARRY SPALLS

### NOTES:

- ALL CATCH BASINS ARE STATIONED TO THE CENTER OF GRATE.

PERMIT STAMP

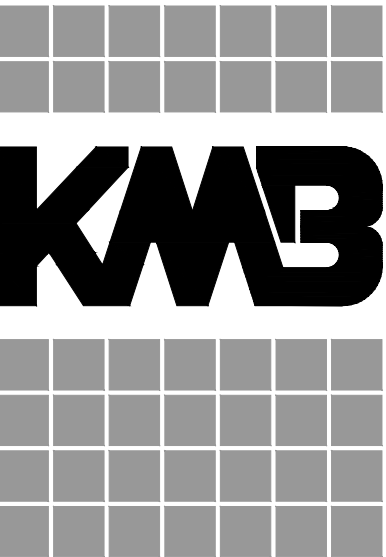
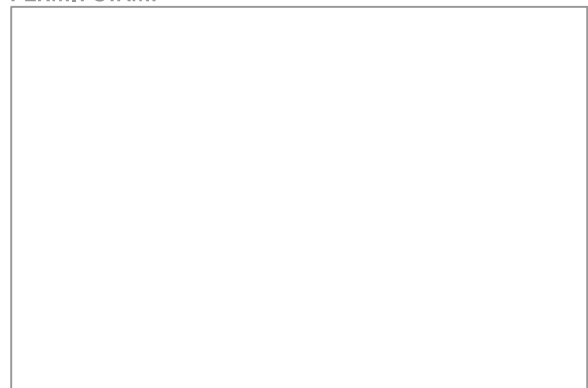

architects

906 Columbia Street SW, Suite 400  
Olympia, Washington 98501  
360.352.8883



08-22-2018  
KMB Project # E1626

HEALTH AND WELLNESS CENTER RENOVATION AND ADDITION  
SOUTH PUGET SOUND COMMUNITY COLLEGE  
2011 MOTTMAN ROAD SW, OLYMPIA, WA 98512  
STATE PROJECT NO. 2018-111A

ORIGINAL SHEET SIZE = 24 x 36  
HALF SIZE REDUCTIONS = 11 x 17

REVISIONS:

DATE:  
07/12/2018

DESIGN DEVELOPMENT

SHEET NO.

C-105

DRAINAGE PLAN



SEC. 28, T18N., R2W., W.M.

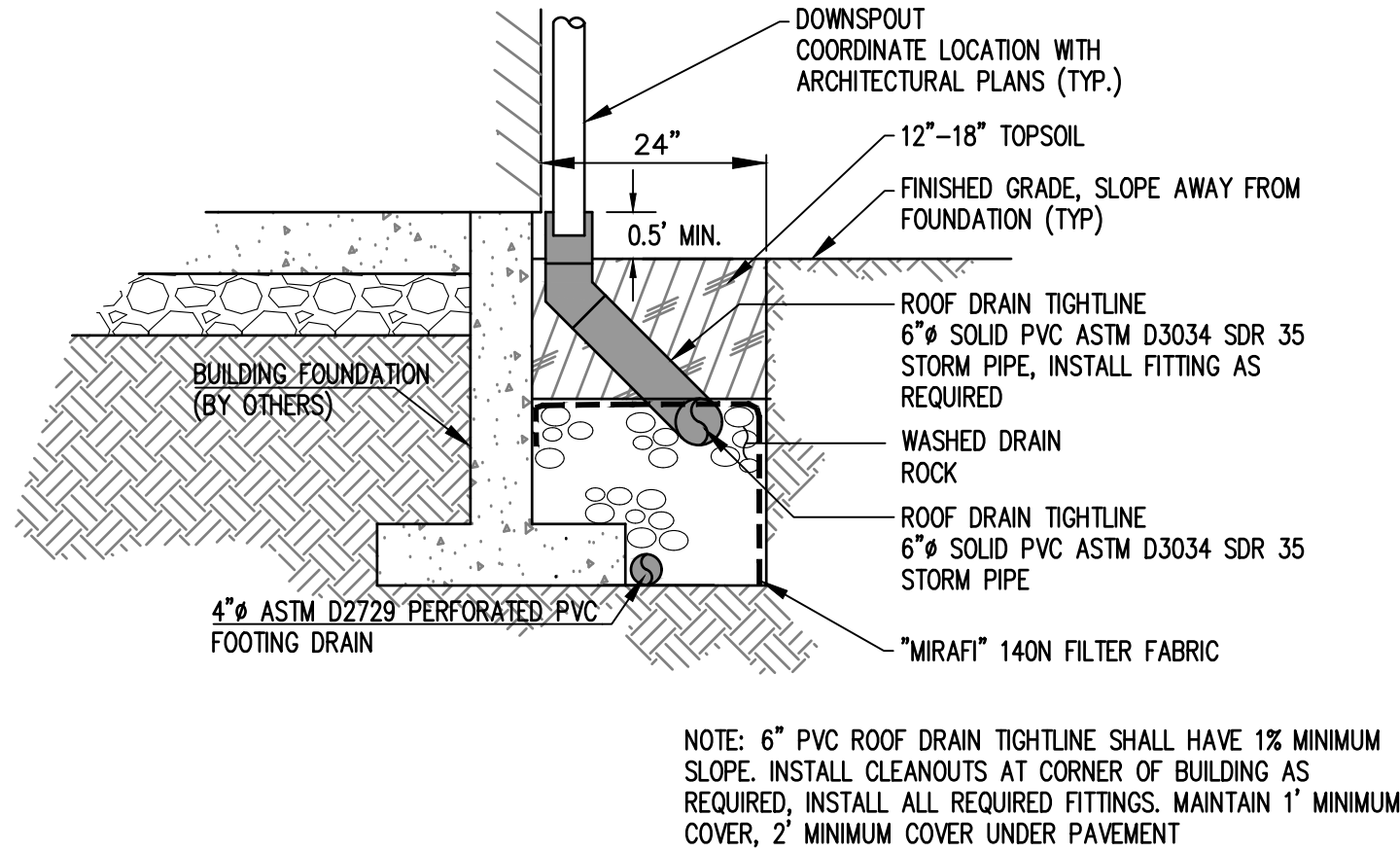

ROOF AND FOOTING DRAIN DETAIL  
NTS



8730 TALLON LANE NE, SUITE 200, LACEY, WA 98516  
P: 360.352.1465 F: 360.352.1509  
SCJALLIANCE.COM

CALL BEFORE YOU DIG

THE CONTRACTOR SHALL BE FULLY RESPONSIBLE FOR THE LOCATION AND PROTECTION OF ALL EXISTING UTILITIES. THE CONTRACTOR SHALL VERIFY ALL UTILITY LOCATIONS PRIOR TO CONSTRUCTION BY CALLING THE UNDERGROUND LOCATE LINE AT (800) 424-5555 A MINIMUM OF 48 HOURS PRIOR TO ANY EXCAVATION.

PERMIT STAMP

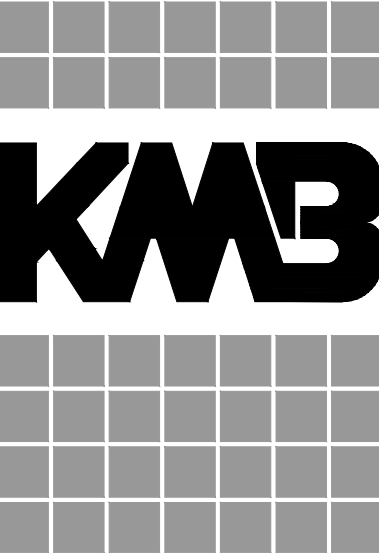

906 Columbia Street SW, Suite 400  
Olympia, Washington 98501  
360.352.8883

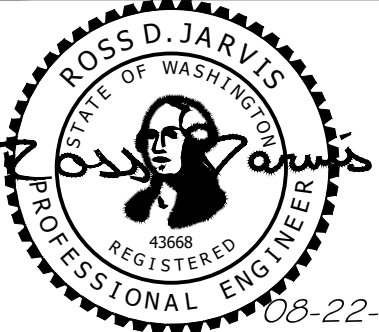

KMB Project # E1626

HEALTH AND WELLNESS CENTER RENOVATION AND ADDITION  
SOUTH PUGET SOUND COMMUNITY COLLEGE  
2011 MOTTMAN ROAD SW, OLYMPIA, WA 98512  
STATE PROJECT NO. 2018-111A

ORIGINAL SHEET SIZE = 24 x 36  
HALF SIZE REDUCTIONS = 11 x 17  
REVISIONS:

DATE:  
07/12/2018  
DESIGN DEVELOPMENT  
SHEET NO.

C-501  
DRAINAGE DETAILS



LAST SAVE: 08/07/2018 11:50 AM  
PLOT: AutoCAD PDF (General Documentation) p33 ARCH Full Bleed D (24.00 x 36.00 inches) SC Fullch - August 22, 2018 (11:50 AM)

### CALL BEFORE YOU DIG

THE CONTRACTOR SHALL BE FULLY RESPONSIBLE FOR THE LOCATION AND PROTECTION OF ALL EXISTING UTILITIES. THE CONTRACTOR SHALL VERIFY ALL UTILITY LOCATIONS PRIOR TO CONSTRUCTION BY CALLING THE UNDERGROUND LOCATE LINE AT (800) 424-5555 A MINIMUM OF 48 HOURS PRIOR TO ANY EXCAVATION.



8730 TALLON LANE NE, SUITE 200, LACEY, WA 98516  
P: 360.352.1465 F: 360.352.1509  
SCJALLIANCE.COM

EX. SSMH 3  
N: 625059.45  
E: 1033431.79  
EXISTING MANHOLE  
RIM: 142.66  
IE OUT: 133.20 (12" E)

SSMH  
RIM = 142.66  
IE TOP 12" PIPE NE = 134.05  
IE TOP 10" PIPE SE = 134.05  
IE TOP PIPE SW = 133.99  
IE TOP PIPE NW = 133.99  
\*PIPES ARE FULL OF SEWAGE.  
ALL INVERTS ARE TO TOP OF PIPES.

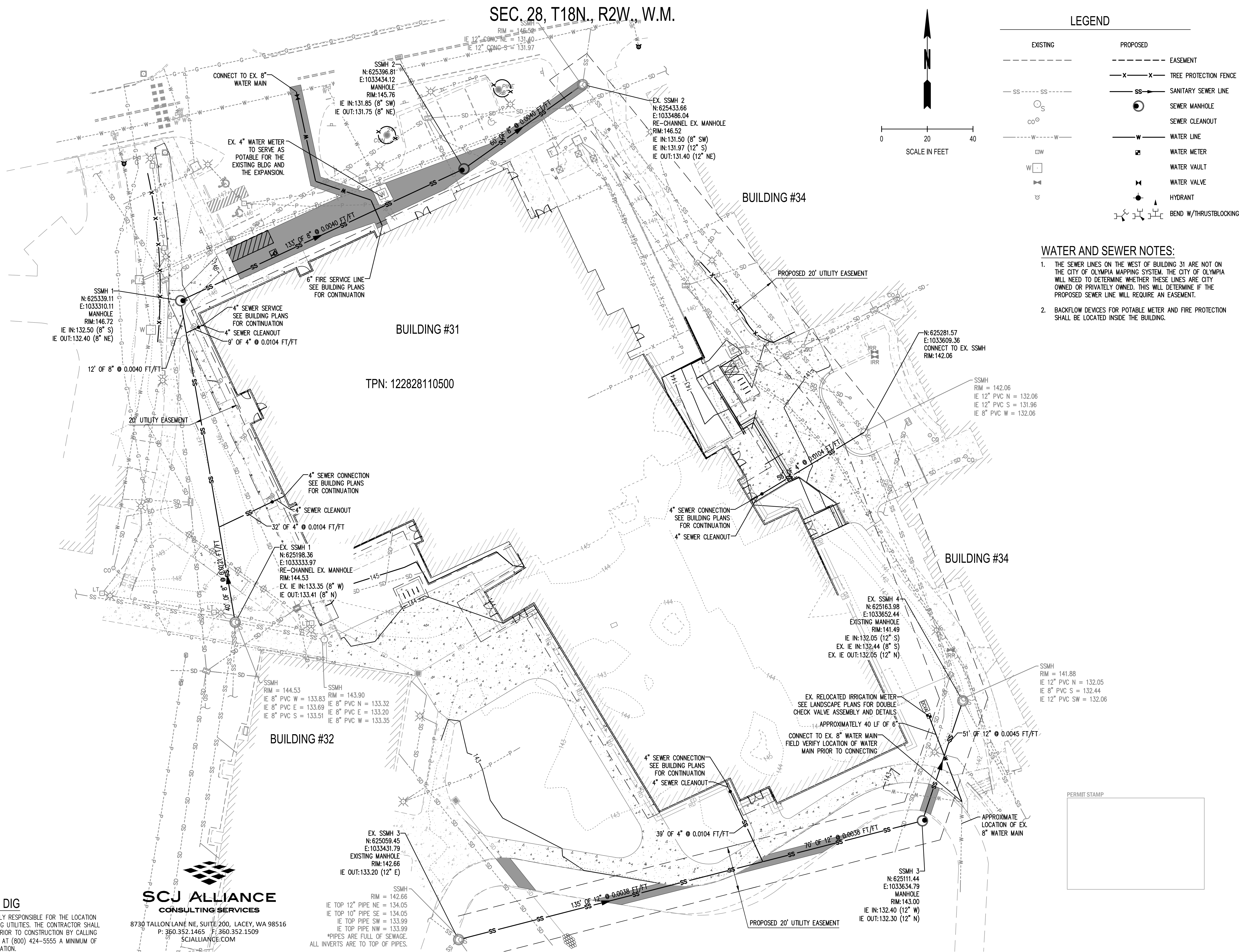

PERMIT STAMP



ORIGINAL SHEET SIZE = 24 x 36  
HALF SIZE REDUCTIONS = 11 x 17

REVISIONS:

DATE:  
07/12/2018

DESIGN DEVELOPMENT

SHEET NO.

C-106

WATER AND  
SEWER PLAN

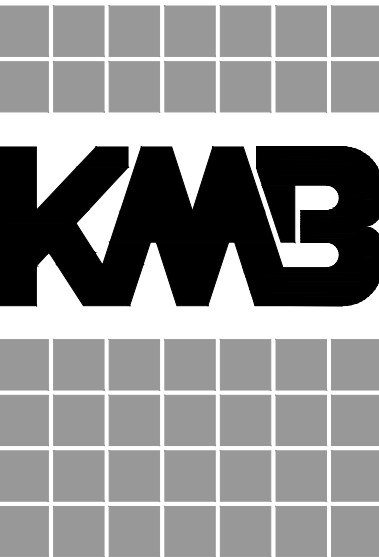

architects

906 Columbia Street SW, Suite 400  
Olympia, Washington 98501  
360.352.8883

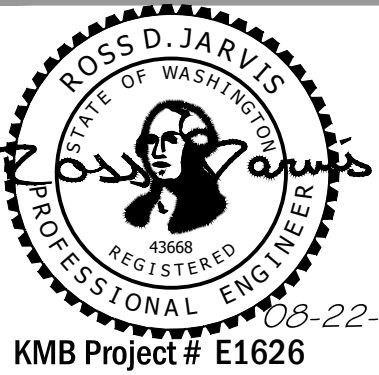

### WATER AND SEWER NOTES:

- THE SEWER LINES ON THE WEST OF BUILDING 31 ARE NOT ON THE CITY OF OLYMPIA MAPPING SYSTEM. THE CITY OF OLYMPIA WILL NEED TO DETERMINE WHETHER THESE LINES ARE CITY OWNED OR PRIVATELY OWNED. THIS WILL DETERMINE IF THE PROPOSED SEWER LINE WILL REQUIRE AN EASEMENT.
- BACKFLOW DEVICES FOR POTABLE METER AND FIRE PROTECTION SHALL BE LOCATED INSIDE THE BUILDING.